First published in the *Government Gazette*, Electronic Edition, on 15th June 2006 at 5:00 pm.

No. S 341

**PROTECTED AREAS AND PROTECTED PLACES ACT
(CHAPTER 256)**

**PROTECTED AREAS (NO. 3)
ORDER 2006**

ARRANGEMENT OF PARAGRAPHS

Paragraph

1. Citation and commencement
2. Premises declared to be protected area

The Schedule

In exercise of the powers conferred by section 4 (1) of the Protected Areas and Protected Places Act, the Minister for Home Affairs hereby makes the following Order:

Citation and commencement

1. This Order may be cited as the Protected Areas (No. 3) Order 2006 and shall come into operation on 15th June 2006.

Premises declared to be protected area

2. The area described in the second column of the Schedule is hereby declared to be a protected area for the purposes of the Act, and every person who is in that area shall comply with such directions for regulating his movement and conduct as may be given by an authorised officer.

 THE SCHEDULE

<i>First column</i>	<i>Second column</i>																																				
The Authority	Protected Area																																				
Commander, Woodlands Command, Immigration & Checkpoints Authority	<p>OLD WOODLANDS CHECKPOINT.</p> <p>All that area comprised in Land Lots 99680P PT, 99624L PT, 99623X PT, 968K PT, 99685X PT, 3921L PT, 967A PT, 99683K, 99607L, 99662N, 99608C, 99591P, 99586W, 99644W, 99645V, 99646P, 99647T, 99596X, 3870V PT, 3871P PT, 99590V, 99584C, 99583L, 99582X, 99581N, 969N PT, 971K PT, 99577K PT, 99603A PT, 99649K PT, 99332W PT and 973X PT in Mukim No. 13 occupied by “OLD WOODLANDS CHECKPOINT” containing an area of about 49,331 square metres and bounded approximately as follows:</p> <p>Commencing at the corner of the aforesaid “OLD WOODLANDS CHECKPOINT” which point is 47,663.172 metres North and 21,043.513 metres East of the Singapore Land Authority SVY 21 Datum, the boundaries run along successive lines of co-ordinates approximately as follows:</p> <table> <tr> <th><i>Northings</i></th><th><i>Easting</i></th></tr> <tr><td>47,661.945</td><td>21,046.009</td></tr> <tr><td>47,659.471</td><td>21,052.031</td></tr> <tr><td>47,656.119</td><td>21,059.831</td></tr> <tr><td>47,608.137</td><td>21,048.048</td></tr> <tr><td>47,608.011</td><td>21,066.685</td></tr> <tr><td>47,586.954</td><td>21,073.280</td></tr> <tr><td>47,584.988</td><td>21,074.694</td></tr> <tr><td>47,578.116</td><td>21,077.433</td></tr> <tr><td>47,563.891</td><td>21,081.753</td></tr> <tr><td>47,556.638</td><td>21,083.427</td></tr> <tr><td>47,551.742</td><td>21,084.310</td></tr> <tr><td>47,546.804</td><td>21,084.625</td></tr> <tr><td>47,536.885</td><td>21,084.409</td></tr> <tr><td>47,524.349</td><td>21,085.264</td></tr> <tr><td>47,499.474</td><td>21,085.778</td></tr> <tr><td>47,499.152</td><td>21,085.905</td></tr> <tr><td>47,482.183</td><td>21,086.268</td></tr> </table>	<i>Northings</i>	<i>Easting</i>	47,661.945	21,046.009	47,659.471	21,052.031	47,656.119	21,059.831	47,608.137	21,048.048	47,608.011	21,066.685	47,586.954	21,073.280	47,584.988	21,074.694	47,578.116	21,077.433	47,563.891	21,081.753	47,556.638	21,083.427	47,551.742	21,084.310	47,546.804	21,084.625	47,536.885	21,084.409	47,524.349	21,085.264	47,499.474	21,085.778	47,499.152	21,085.905	47,482.183	21,086.268
<i>Northings</i>	<i>Easting</i>																																				
47,661.945	21,046.009																																				
47,659.471	21,052.031																																				
47,656.119	21,059.831																																				
47,608.137	21,048.048																																				
47,608.011	21,066.685																																				
47,586.954	21,073.280																																				
47,584.988	21,074.694																																				
47,578.116	21,077.433																																				
47,563.891	21,081.753																																				
47,556.638	21,083.427																																				
47,551.742	21,084.310																																				
47,546.804	21,084.625																																				
47,536.885	21,084.409																																				
47,524.349	21,085.264																																				
47,499.474	21,085.778																																				
47,499.152	21,085.905																																				
47,482.183	21,086.268																																				

 THE SCHEDULE — *continued*

<i>First column</i>	<i>Second column</i>	
The Authority	Protected Area	
	<i>Northing</i>	<i>Easting</i>
	47,449.129	21,086.750
	47,425.415	21,087.215
	47,416.257	21,087.297
	47,398.576	21,087.696
	47,386.728	21,087.851
	47,369.411	21,088.192
	47,344.709	21,088.636
	47,322.450	21,089.036
	47,288.982	21,089.638
	47,254.230	21,090.468
	47,239.384	21,090.709
	47,229.517	21,091.080
	47,222.044	21,091.159
	47,164.079	21,092.675
	47,160.066	21,080.762
	47,161.333	21,074.890
	47,162.693	21,068.921
	47,163.873	21,064.221
	47,172.750	21,060.820
	47,177.753	21,058.690
	47,185.616	21,055.197
	47,190.773	21,052.452
	47,195.813	21,049.421
	47,200.619	21,046.064
	47,205.293	21,042.467
	47,209.732	21,038.627
	47,213.886	21,034.463
	47,217.685	21,029.981
	47,221.402	21,025.452
	47,224.848	21,020.711

THE SCHEDULE — *continued*

<i>First column</i>	<i>Second column</i>	
The Authority	Protected Area	
	<i>Northing</i>	<i>Easting</i>
	47,228.130	21,015.861
	47,229.310	21,013.189
	47,231.364	21,007.675
	47,233.330	21,002.159
	47,234.936	20,996.465
	47,236.931	20,987.924
	47,238.632	20,984.091
	47,238.425	20,979.231
	47,238.528	20,973.344
	47,238.008	20,961.583
	47,237.736	20,958.694
	47,237.457	20,955.769
	47,235.619	20,947.169
	47,234.223	20,941.453
	47,233.257	20,938.703
	47,225.067	20,926.491
	47,223.202	20,924.222
	47,221.519	20,921.806
	47,221.907	20,918.881
	47,223.252	20,916.203
	47,234.423	20,919.997
	47,237.086	20,921.259
	47,262.993	20,935.002
	47,281.146	20,944.631
	47,286.512	20,934.033
	47,289.686	20,927.657
	47,295.022	20,916.954
	47,295.245	20,917.057
	47,295.348	20,916.679
	47,295.650	20,916.773

 THE SCHEDULE — *continued*

<i>First column</i>	<i>Second column</i>	
The Authority	Protected Area	
	<i>Northing</i>	<i>Easting</i>
	47,359.837	20,942.663
	47,374.454	20,948.455
	47,387.019	20,953.619
	47,430.842	20,971.262
	47,430.424	20,972.246
	47,431.168	20,972.498
	47,432.053	20,980.043
	47,438.055	20,978.798
	47,443.820	20,977.102
	47,483.745	20,965.269
	47,483.947	20,965.894
	47,486.086	20,973.391
	47,460.802	20,981.048
	47,460.640	20,982.124
	47,468.408	20,982.444
	47,485.160	20,987.606
	47,498.580	20,991.734
	47,519.357	20,997.935
	47,532.399	21,002.078
	47,542.142	21,004.976
	47,542.960	21,005.254
	47,556.656	21,000.197
	47,581.997	20,990.734
	47,585.336	20,998.905
	47,585.718	21,000.103
	47,585.549	21,000.479
	47,569.048	21,006.490
	47,558.269	21,010.467
	47,561.458	21,011.553
	47,564.599	21,012.048

THE SCHEDULE — *continued*

<i>First column</i>		<i>Second column</i>	
The Authority		Protected Area	
	<i>Northing</i>		<i>Easting</i>
	47,581.973		21,017.333
	47,613.752		21,027.148
	47,631.874		21,033.283

to the point of commencement.

The boundaries of “OLD WOODLANDS CHECK-POINT” are more particularly delineated in the plan set out below.

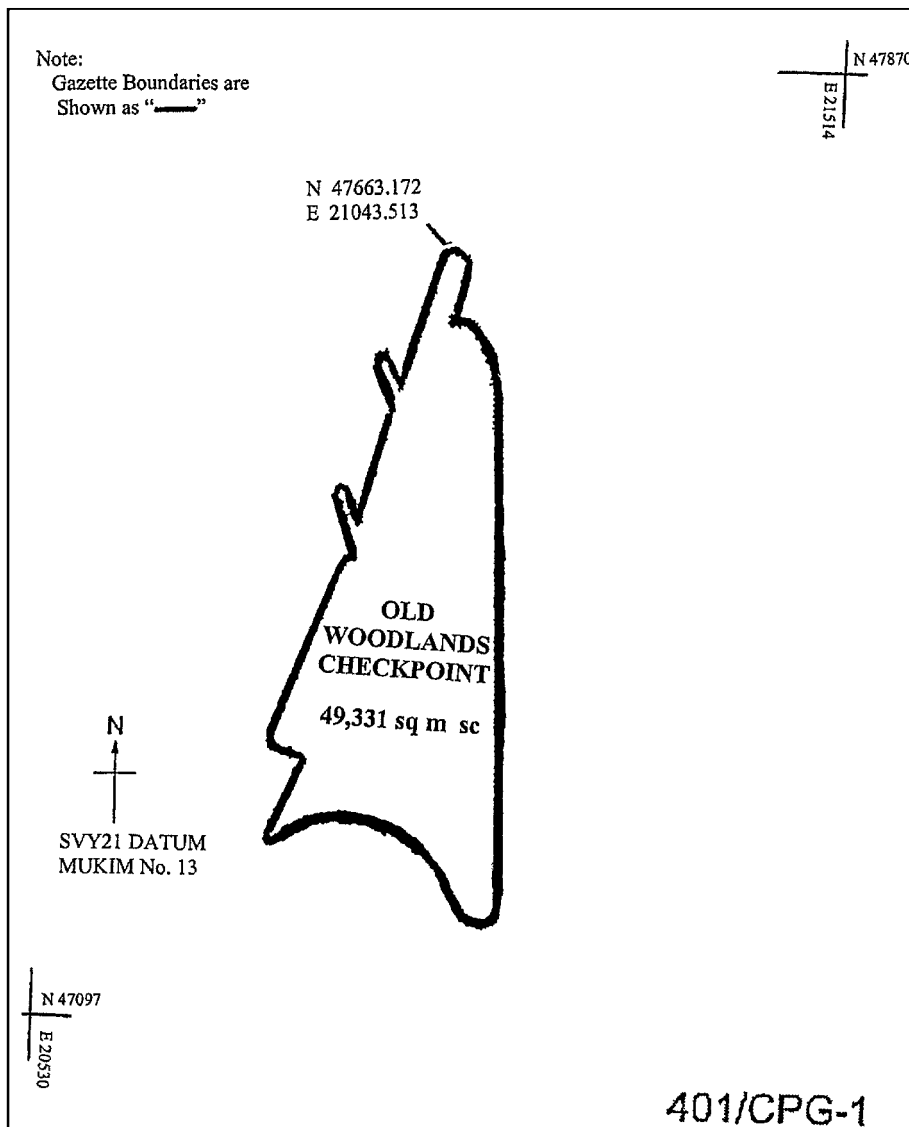
THE SCHEDULE — *continued*

Made this 8th day of June 2006.

BENNY LIM
*Permanent Secretary,
Ministry of Home Affairs,
Singapore.*

[MHA(PS) 12/2/07 TF 2; MHA(PS) 12/2/01 TF 3;
AG/LEG/SL/256/2002/1 Vol. 8]