First published in the *Government Gazette*, Electronic Edition, on 25th January 2006 at 5:00 pm.

No. S 41

**PROTECTED AREAS AND PROTECTED PLACES ACT
(CHAPTER 256)**

**PROTECTED PLACES (NO. 2)
ORDER 2006**

ARRANGEMENT OF PARAGRAPHS

Paragraph

1. Citation and commencement
 2. Premises declared to be protected places
- The Schedule
-

In exercise of the powers conferred by section 5 (1) of the Protected Areas and Protected Places Act, the Minister for Home Affairs hereby makes the following Order:

Citation and commencement

1. This Order may be cited as the Protected Places (No. 2) Order 2006 and shall come into operation on 25th January 2006.

Premises declared to be protected places

2. The premises described in the second column of the Schedule are hereby declared to be protected places for the purposes of the Act, and no person shall be in those premises unless he is in possession of a pass-card or permit issued by the authority specified in the first column of the Schedule or has received the permission of an authorised officer on duty at the premises to enter the premises.

 THE SCHEDULE

First column
 The Authority
 Director,
 3P Network Department

Second column
 Protected Place
 (1) UPPER PEIRCE OUTLET WORKS.

All that area comprised in part of State Land Lot MK15-2506A-PART, off Old Upper Thomson Road, occupied by “UPPER PEIRCE OUTLET WORKS” containing an area of about 4,583.287 square metres and bounded approximately as follows:

Commencing at the corner of the aforesaid “UPPER PEIRCE OUTLET WORKS” which point is 39,230.154 metres North and 24,812.054 metres East of the Singapore Land Authority SVY 21 Datum, the boundaries run along successive lines of co-ordinates approximately as follows:

| <i>Northings</i> | <i>Easting</i> |
|------------------|----------------|
| 39,226.219 | 24,819.185 |
| 39,219.845 | 24,830.566 |
| 39,214.943 | 24,839.134 |
| 39,192.892 | 24,821.310 |
| 39,191.295 | 24,848.679 |
| 39,158.063 | 24,844.997 |
| 39,158.369 | 24,833.895 |
| 39,151.912 | 24,833.541 |
| 39,153.010 | 24,786.681 |
| 39,150.928 | 24,786.534 |
| 39,149.432 | 24,783.394 |
| 39,015.316 | 24,781.297 |
| 39,014.593 | 24,783.625 |
| 39,013.938 | 24,784.893 |
| 39,012.833 | 24,786.325 |
| 39,011.441 | 24,787.675 |
| 39,019.009 | 24,788.575 |
| 39,008.412 | 24,789.189 |
| 39,006.530 | 24,789.645 |
| 39,004.074 | 24,789.727 |

THE SCHEDULE — *continued*

| <i>First column</i> | | <i>Second column</i> | |
|---------------------|-----------------|----------------------|----------------|
| The Authority | | Protected Place | |
| | <i>Northing</i> | | <i>Easting</i> |
| | 39,002.109 | | 24,789.278 |
| | 39,000.227 | | 24,788.460 |
| | 38,998.590 | | 24,787.397 |
| | 38,997.198 | | 24,785.843 |
| | 38,996.298 | | 24,784.493 |
| | 38,995.643 | | 24,783.144 |
| | 38,995.152 | | 24,781.467 |
| | 38,995.028 | | 24,779.525 |
| | 38,995.193 | | 24,777.704 |
| | 38,995.643 | | 24,775.986 |
| | 38,996.502 | | 24,774.186 |
| | 38,997.689 | | 24,772.672 |
| | 38,998.794 | | 24,771.526 |
| | 39,000.145 | | 24,770.667 |
| | 39,001.782 | | 24,769.930 |
| | 39,003.747 | | 24,769.398 |
| | 39,005.232 | | 24,769.317 |
| | 39,007.021 | | 24,769.479 |
| | 39,009.191 | | 24,770.092 |
| | 39,011.237 | | 24,771.278 |
| | 39,012.874 | | 24,772.791 |
| | 39,014.225 | | 24,774.631 |
| | 39,015.002 | | 24,776.554 |
| | 39,015.362 | | 24,778.297 |
| | 39,149.598 | | 24,780.371 |
| | 39,151.940 | | 24,776.174 |
| | 39,175.207 | | 24,777.515 |
| | 39,177.791 | | 24,775.591 |
| | 39,181.667 | | 24,772.916 |
| | 39,205.707 | | 24,795.378 |

THE SCHEDULE — *continued*

| <i>First column</i> | <i>Second column</i> | |
|---------------------|----------------------|----------------|
| The Authority | Protected Place | |
| | <i>Northing</i> | <i>Easting</i> |
| | 39,214.480 | 24,801.683 |
| | 39,215.394 | 24,802.348 |

to the point of commencement.

The boundaries of “UPPER PEIRCE OUTLET WORKS” are more particularly delineated in the Plan set out below.

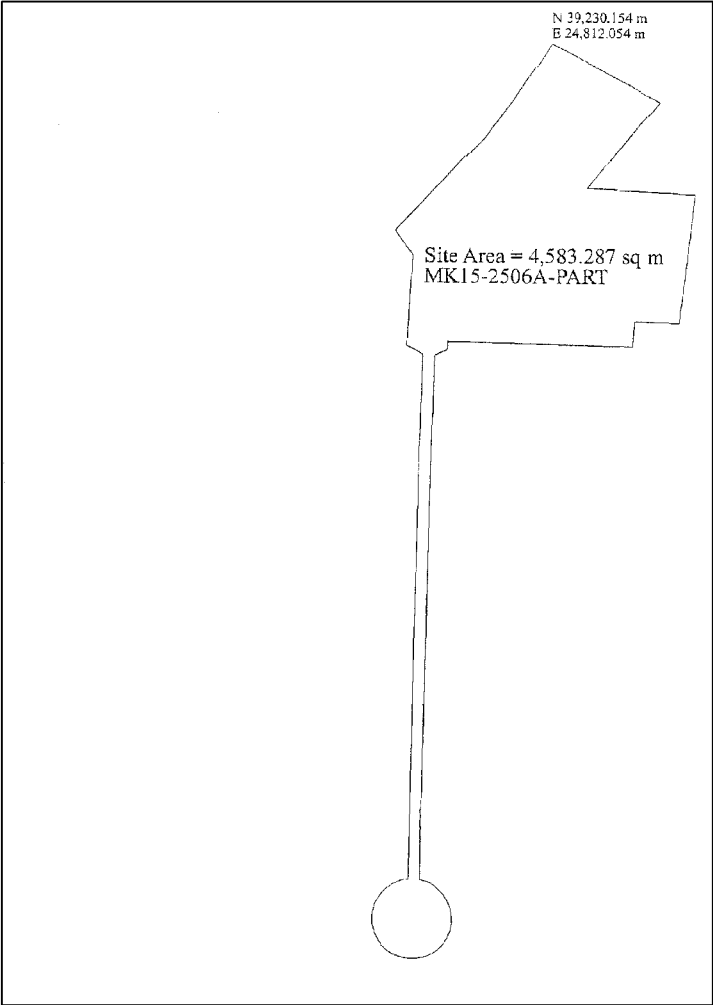

 THE SCHEDULE — *continued*

First column
The Authority

Second column
Protected Place

(2) LOWER PEIRCE PUMPING STATION.

All that area comprised in part of State Land Lot MK15-2506A-PART, Old Upper Thomson Road, occupied by “LOWER PEIRCE PUMPING STATION” containing an area of about 4,578.747 square metres and bounded approximately as follows:

Commencing at the corner of the aforesaid “LOWER PEIRCE PUMPING STATION” which point is 39,150.511 metres North and 27,326.989 metres East of the Singapore Land Authority SVY 21 Datum, the boundaries run along successive lines of co-ordinates approximately as follows:

| <i>Northing</i> | <i>Easting</i> |
|-----------------|----------------|
| 39,149.251 | 27,327.754 |
| 39,144.838 | 27,330.693 |
| 39,138.204 | 27,330.325 |
| 39,116.700 | 27,332.882 |
| 39,113.186 | 27,330.731 |
| 39,100.713 | 27,349.259 |
| 39,068.985 | 27,327.395 |
| 39,061.545 | 27,324.927 |
| 39,057.088 | 27,322.142 |
| 39,051.642 | 27,318.668 |
| 39,060.770 | 27,301.915 |
| 39,064.279 | 27,297.419 |
| 39,068.224 | 27,292.947 |
| 39,128.069 | 27,264.705 |
| 39,129.617 | 27,267.705 |
| 39,134.776 | 27,278.533 |
| 39,135.328 | 27,279.885 |
| 39,140.074 | 27,287.821 |
| 39,146.207 | 27,298.168 |
| 39,135.504 | 27,303.330 |

to the point of commencement.

THE SCHEDULE — *continued*

First column
The Authority

Second column
Protected Place

The boundaries of “LOWER PEIRCE PUMPING STATION” are more particularly delineated in the Plan set out below.

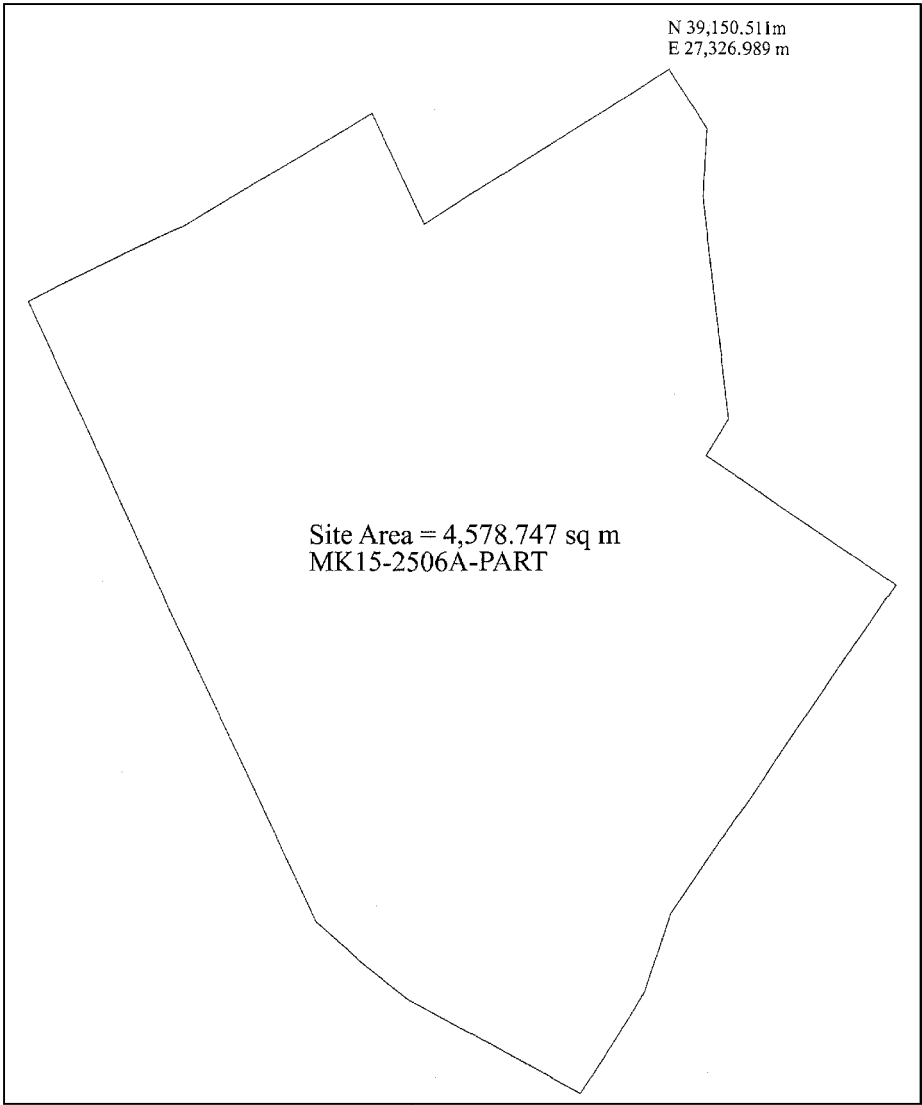

 THE SCHEDULE — *continued*

First column
The Authority

Second column
Protected Place

(3) MACRITCHIE I PUMPING STATION.

All that area comprised in part of State Land Lot MK17-5941W-PART, Reservoir Road off Lornie Road, occupied by “MACRITCHIE I PUMPING STATION” containing an area of about 1,317.877 square metres and bounded approximately as follows:

Commencing at the corner of the aforesaid “MACRITCHIE I PUMPING STATION” which point is 36,019.168 metres North and 28,066.299 metres East of the Singapore Land Authority SVY 21 Datum, the boundaries run along successive lines of co-ordinates approximately as follows:

| <i>Northing</i> | <i>Easting</i> |
|-----------------|----------------|
| 36,010.147 | 28,102.975 |
| 36,008.484 | 28,108.644 |
| 36,002.183 | 28,108.290 |
| 35,990.410 | 28,107.229 |
| 35,986.107 | 28,106.791 |
| 35,985.675 | 28,106.663 |
| 35,985.660 | 28,076.746 |
| 35,988.143 | 28,067.935 |
| 35,989.622 | 28,062.784 |
| 35,991.483 | 28,056.299 |
| 35,994.543 | 28,057.325 |
| 35,997.262 | 28,058.236 |
| 36,001.270 | 28,059.615 |
| 36,003.978 | 28,060.557 |
| 36,005.980 | 28,061.253 |
| 36,007.026 | 28,061.616 |
| 36,008.643 | 28,062.311 |
| 36,013.225 | 28,064.281 |
| 36,014.592 | 28,064.841 |

to the point of commencement.

THE SCHEDULE — *continued*

First column
The Authority

Second column
Protected Place

The boundaries of “MACRITCHIE I PUMPING STATION” are more particularly delineated in the Plan set out below.

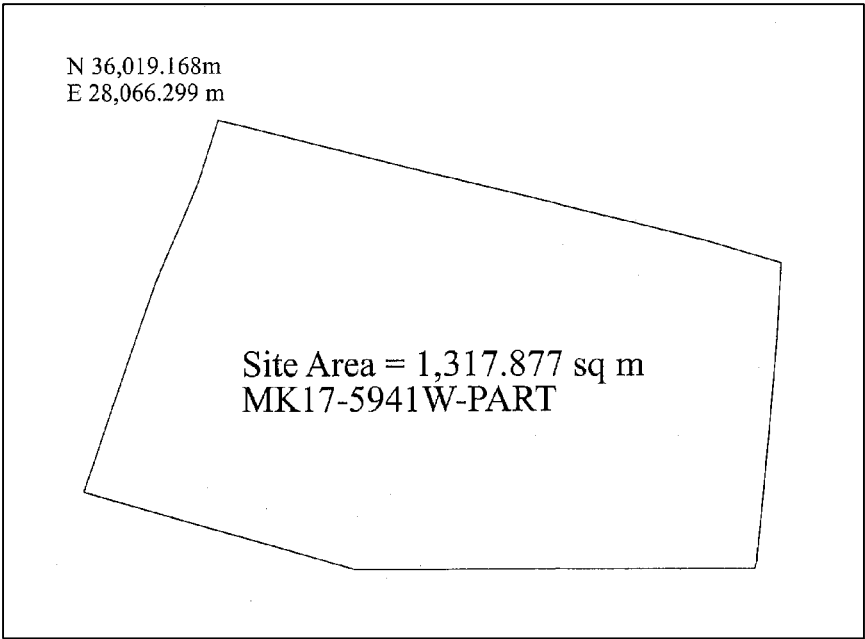

 THE SCHEDULE — *continued*

First column
The Authority

Second column
Protected Place

(4) MACRITCHIE II PUMPING STATION.

All that area comprised in part of State Land Lot MK17-5941W-PART, Reservoir Road off Lornie Road, occupied by “MACRITCHIE II PUMPING STATION” containing an area of about 1,052.995 square metres and bounded approximately as follows:

Commencing at the corner of the aforesaid “MACRITCHIE II PUMPING STATION” which point is 36,117.639 metres North and 28,229.215 metres East of the Singapore Land Authority SVY 21 Datum, the boundaries run along successive lines of co-ordinates approximately as follows:

| <i>Northing</i> | <i>Easting</i> |
|-----------------|----------------|
| 36,113.774 | 28,232.941 |
| 36,109.246 | 28,236.985 |
| 36,106.055 | 28,239.804 |
| 36,103.842 | 28,241.896 |
| 36,099.891 | 28,241.917 |
| 36,095.442 | 28,241.886 |
| 36,094.657 | 28,241.868 |
| 36,089.423 | 28,241.781 |
| 36,076.731 | 28,241.608 |
| 36,071.502 | 28,241.363 |
| 36,071.412 | 28,239.144 |
| 36,071.352 | 28,237.422 |
| 36,071.309 | 28,233.148 |
| 36,071.217 | 28,229.814 |
| 36,071.232 | 28,224.844 |
| 36,089.812 | 28,212.678 |
| 36,105.391 | 28,212.464 |
| 36,114.407 | 28,224.605 |
| 36,117.009 | 28,228.130 |

to the point of commencement.

THE SCHEDULE — *continued*

First column
The Authority

Second column
Protected Place

The boundaries of “MACRITCHIE II PUMPING STATION” are more particularly delineated in the Plan set out below.

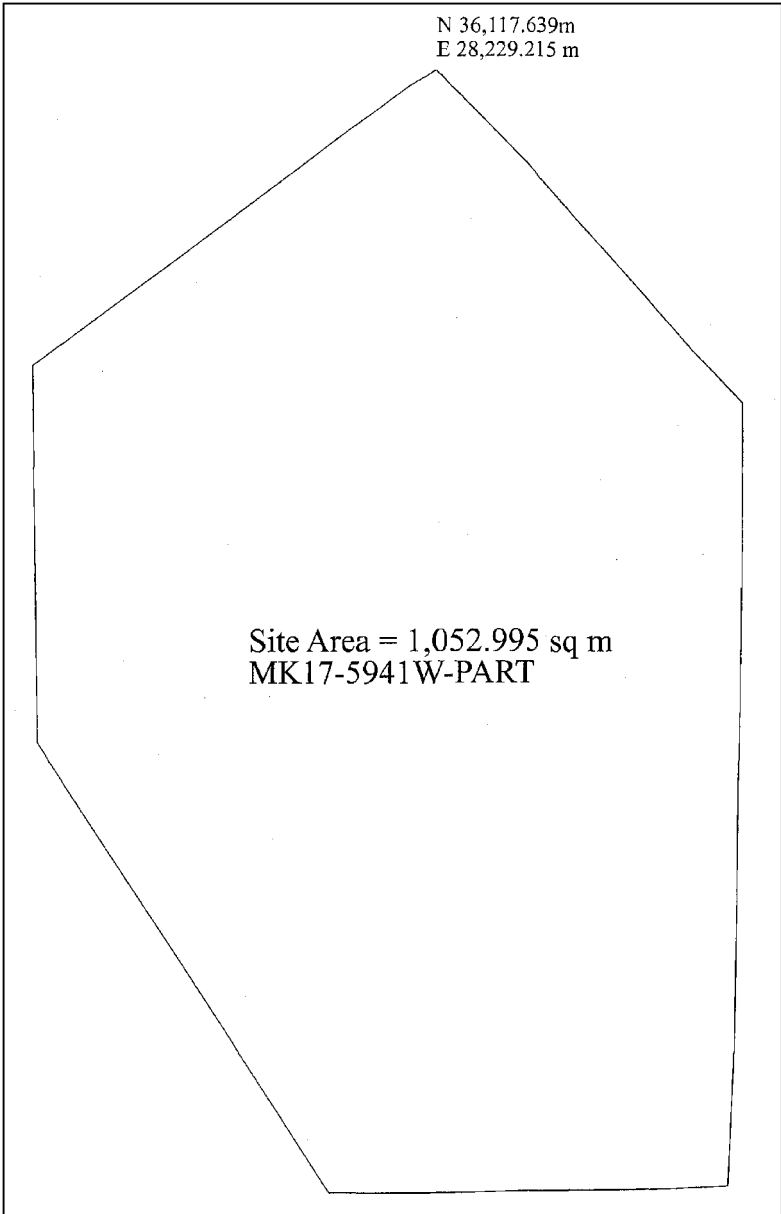

 THE SCHEDULE — *continued*

First column
The Authority

Second column
Protected Place

(5) BEDOK PUMPING STATION.

All that area comprised in part of State Land Lots MK28-6720A-PART and MK28-6388W-PART, Tampines Avenue 10, occupied by “BEDOK PUMPING STATION” containing an area of about 5,126.229 square metres and bounded approximately as follows:

Commencing at the corner of the aforesaid “BEDOK PUMPING STATION” which point is 36,161.576 metres North and 37,609.096 metres East of the Singapore Land Authority SVY 21 Datum, the boundaries run along successive lines of co-ordinates approximately as follows:

| <i>Northing</i> | <i>Easting</i> |
|-----------------|----------------|
| 36,127.547 | 37,626.706 |
| 36,133.239 | 37,637.278 |
| 36,127.934 | 37,640.027 |
| 36,152.459 | 37,685.217 |
| 36,152.960 | 37,685.092 |
| 36,155.053 | 37,689.059 |
| 36,149.148 | 37,692.223 |
| 36,145.977 | 37,686.107 |
| 36,147.933 | 37,684.992 |
| 36,124.630 | 37,641.836 |
| 36,116.310 | 37,646.229 |
| 36,110.662 | 37,635.801 |
| 36,063.545 | 37,660.814 |
| 36,046.489 | 37,628.351 |
| 36,068.281 | 37,616.760 |
| 36,067.757 | 37,614.964 |
| 36,067.441 | 37,613.879 |
| 36,067.253 | 37,612.954 |
| 36,067.288 | 37,612.318 |
| 36,067.407 | 37,611.530 |

THE SCHEDULE — *continued*

| <i>First column</i> | <i>Second column</i> | |
|---------------------|----------------------|------------|
| The Authority | Protected Place | |
| | 36,067.647 | 37,610.788 |
| | 36,068.419 | 37,608.923 |
| | 36,068.875 | 37,607.965 |
| | 36,069.264 | 37,607.313 |
| | 36,069.711 | 37,606.723 |
| | 36,070.169 | 37,606.275 |
| | 36,070.835 | 37,605.811 |
| | 36,118.263 | 37,580.593 |
| | 36,123.483 | 37,583.423 |
| | 36,142.537 | 37,573.246 |

to the point of commencement.

The boundaries of “BEDOK PUMPING STATION” are more particularly delineated in the Plan set out below.

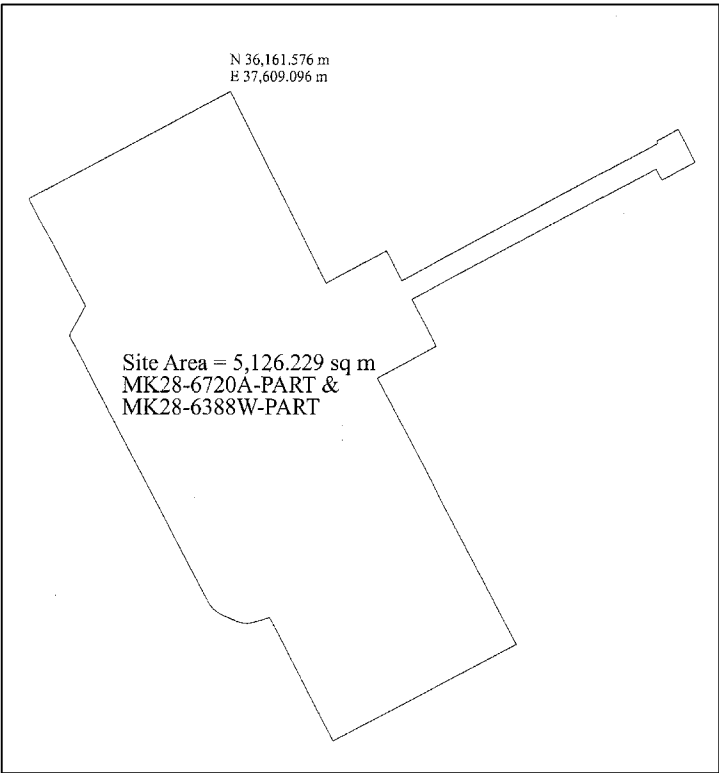

 THE SCHEDULE — *continued*

First column
The Authority

Second column
Protected Place

(6) KRANJI I PUMPING STATION.

All that area comprised in part of State Land Lot MK12-951V-PART, off Neo Tiew Lane 2, occupied by “KRANJI I PUMPING STATION” containing an area of about 4,027.755 square metres and bounded approximately as follows:

Commencing at the corner of the aforesaid “KRANJI I PUMPING STATION” which point is 44,203.942 metres North and 16,377.083 metres East of the Singapore Land Authority SVY 21 Datum, the boundaries run along successive lines of co-ordinates approximately as follows:

| <i>Northings</i> | <i>Easting</i> |
|------------------|----------------|
| 44,170.950 | 16,411.132 |
| 44,149.899 | 16,389.300 |
| 44,143.769 | 16,395.363 |
| 44,132.276 | 16,383.824 |
| 44,138.108 | 16,378.144 |
| 44,131.848 | 16,370.343 |
| 44,117.668 | 16,357.621 |
| 44,117.158 | 16,357.165 |
| 44,115.618 | 16,355.566 |
| 44,142.039 | 16,329.249 |
| 44,138.434 | 16,325.965 |
| 44,148.937 | 16,317.469 |
| 44,153.534 | 16,322.066 |
| 44,174.091 | 16,342.676 |
| 44,178.885 | 16,343.100 |
| 44,182.196 | 16,347.053 |
| 44,181.398 | 16,354.068 |

to the point of commencement.

THE SCHEDULE — continued

First column
The Authority

Second column
Protected Place

The boundaries of “KRANJI I PUMPING STATION” are more particularly delineated in the Plan set out below.

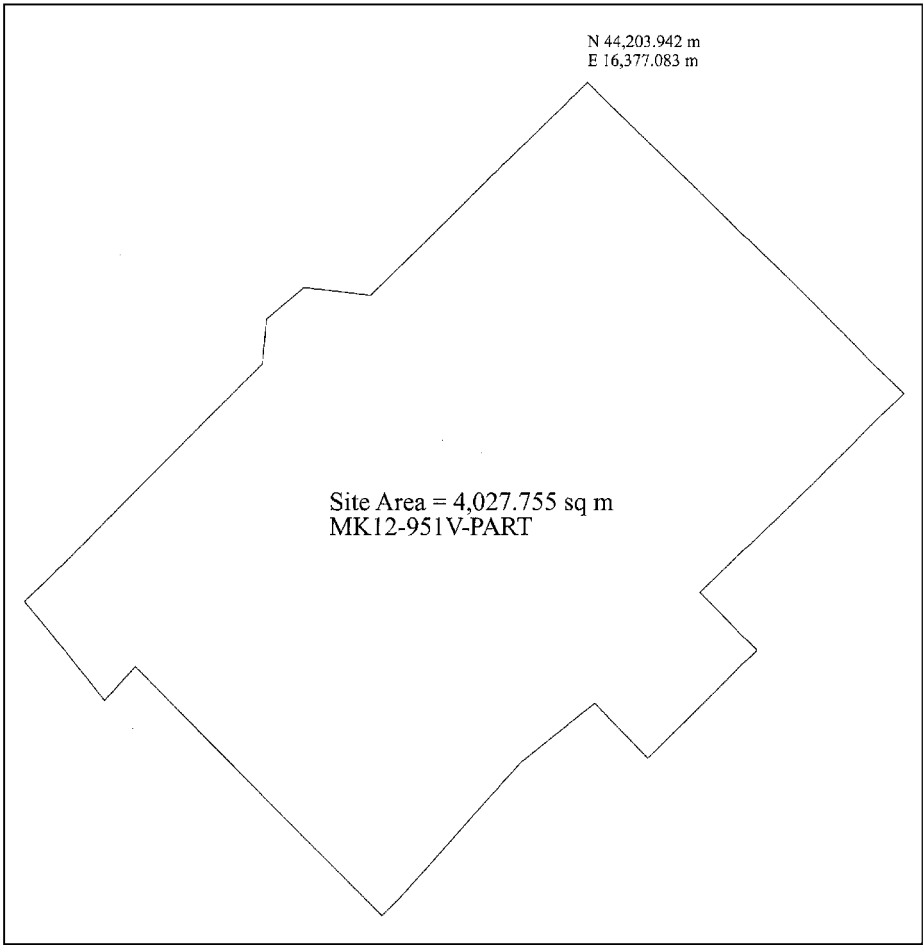

 THE SCHEDULE — *continued*

First column
The Authority

Second column
Protected Place

(7) KRANJI II PUMPING STATION.

All that area comprised in part of State Land Lot MK11-3249K-PART, off Sungei Kadut Drive, occupied by “KRANJI II PUMPING STATION” containing an area of about 1,314.390 square metres and bounded approximately as follows:

Commencing at the corner of the aforesaid “KRANJI II PUMPING STATION” which point is 45,203.413 metres North and 18,103.332 metres East of the Singapore Land Authority SVY 21 Datum, the boundaries run along successive lines of co-ordinates approximately as follows:

| <i>Northing</i> | <i>Easting</i> |
|-----------------|----------------|
| 45,186.920 | 18,128.982 |
| 45,180.275 | 18,124.781 |
| 45,173.784 | 18,135.115 |
| 45,172.440 | 18,134.801 |
| 45,167.555 | 18,132.662 |
| 45,166.900 | 18,131.105 |
| 45,167.009 | 18,117.894 |
| 45,155.815 | 18,107.259 |
| 45,171.384 | 18,082.638 |
| 45,183.085 | 18,090.208 |
| 45,188.215 | 18,093.425 |

to the point of commencement.

THE SCHEDULE — *continued*

First column
The Authority

Second column
Protected Place

The boundaries of “KRANJI II PUMPING STATION” are more particularly delineated in the Plan set out below.

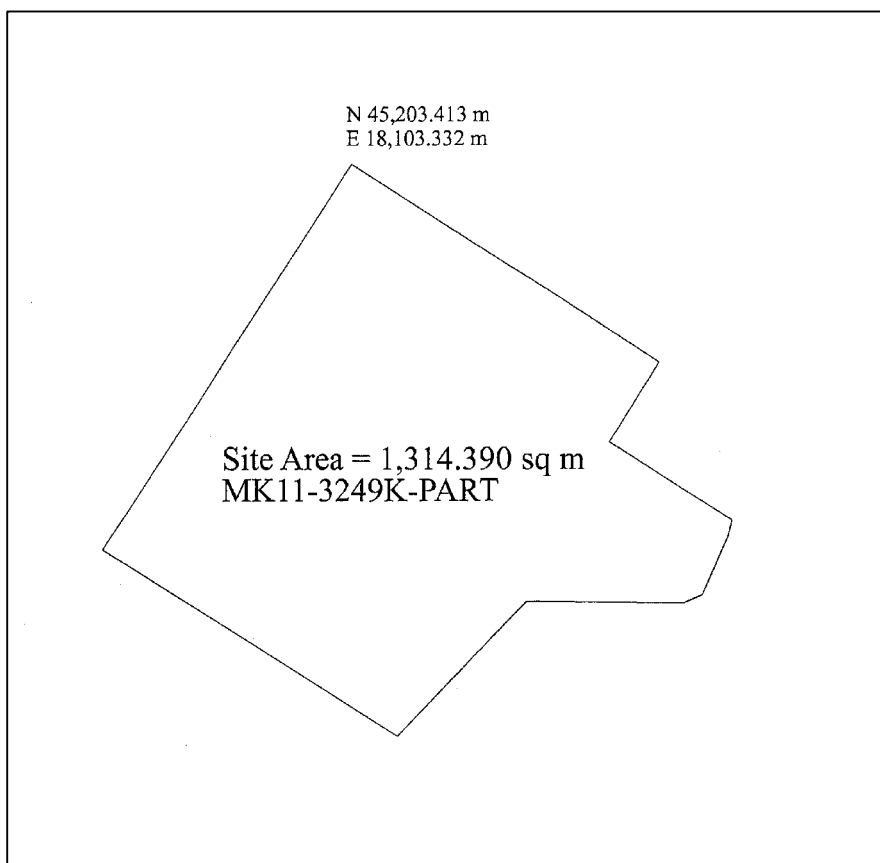

 THE SCHEDULE — *continued*

First column
The Authority

Second column
Protected Place

(8) PANDAN II PUMPING STATION.

All that area comprised in part of State Land Lot MK05-99779W-PART, off West Coast Road, occupied by “PANDAN II PUMPING STATION” containing an area of about 1,429.720 square metres and bounded approximately as follows:

Commencing at the corner of the aforesaid “PANDAN II PUMPING STATION” which point is 33,466.275 metres North and 17,883.386 metres East of the Singapore Land Authority SVY 21 Datum, the boundaries run along successive lines of co-ordinates approximately as follows:

| <i>Northing</i> | <i>Easting</i> |
|-----------------|----------------|
| 33,459.171 | 17,917.572 |
| 33,458.056 | 17,922.776 |
| 33,453.854 | 17,942.751 |
| 33,452.738 | 17,947.936 |
| 33,451.861 | 17,951.797 |
| 33,433.556 | 17,947.410 |
| 33,441.158 | 17,911.049 |
| 33,441.234 | 17,909.658 |
| 33,434.812 | 17,908.379 |
| 33,436.323 | 17,902.112 |
| 33,441.516 | 17,903.365 |
| 33,443.726 | 17,901.317 |
| 33,449.254 | 17,874.706 |
| 33,461.595 | 17,877.118 |
| 33,463.203 | 17,879.176 |
| 33,465.778 | 17,882.686 |

to the point of commencement.

THE SCHEDULE — *continued*

First column
The Authority

Second column
Protected Place

The boundaries of “PANDAN II PUMPING STATION” are more particularly delineated in the Plan set out below.

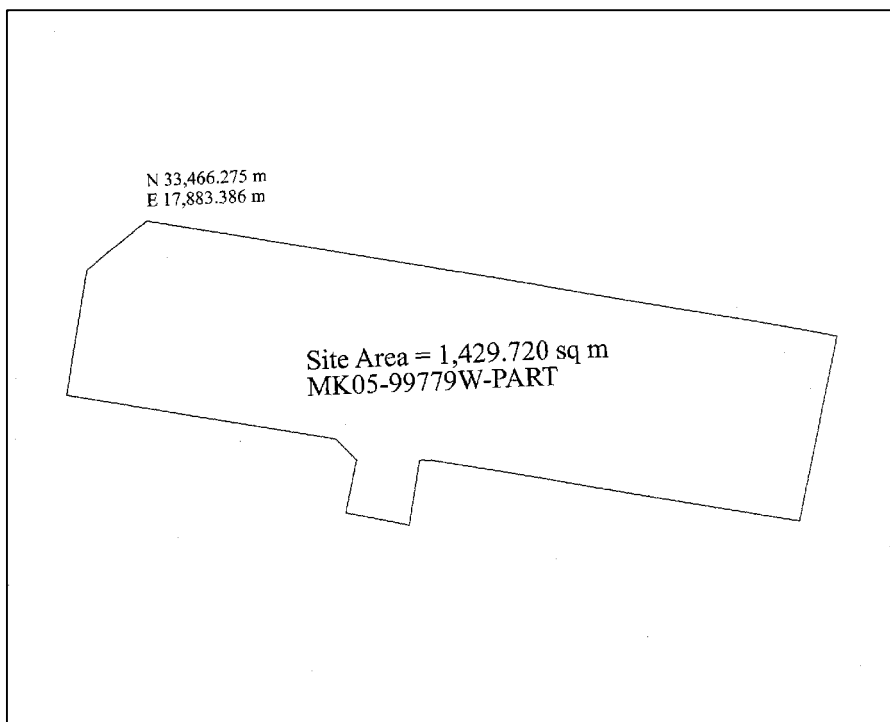

 THE SCHEDULE — *continued*

| <i>First column</i> | <i>Second column</i> |
|---------------------|-------------------------------------------------------------------------------------------------------------------------------------------------------------------------------------------------------------------------------------------------------------------------------|
| The Authority | Protected Place |
| | (9) LOWER SELETAR PUMPING STATION. |
| | All that area comprised in part of State Land Lot MK20-3884V-PART, Seletar Club Road, occupied by “LOWER SELETAR PUMPING STATION” containing an area of about 11,294.145 square metres and bounded approximately as follows: |
| | Commencing at the corner of the aforesaid “LOWER SELETAR PUMPING STATION” which point is 44,278.994 metres North and 30,974.169 metres East of the Singapore Land Authority SVY 21 Datum, the boundaries run along successive lines of co-ordinates approximately as follows: |
| <i>Northing</i> | <i>Easting</i> |
| 44,278.899 | 30,974.286 |
| 44,277.591 | 30,973.221 |
| 44,276.637 | 30,974.571 |
| 44,270.558 | 30,982.213 |
| 44,270.450 | 30,982.319 |
| 44,230.219 | 31,032.208 |
| 44,194.328 | 31,003.012 |
| 44,190.351 | 30,999.737 |
| 44,117.648 | 30,940.633 |
| 44,165.252 | 30,881.789 |
| 44,164.979 | 30,881.569 |
| 44,165.073 | 30,881.452 |
| 44,169.187 | 30,884.769 |
| 44,173.082 | 30,887.905 |
| 44,203.884 | 30,912.869 |
| 44,212.513 | 30,902.275 |
| 44,213.000 | 30,902.606 |
| 44,226.335 | 30,913.275 |
| 44,226.602 | 30,913.488 |
| 44,226.899 | 30,913.827 |

 THE SCHEDULE — *continued*

| <i>First column</i> | | <i>Second column</i> |
|---------------------|------------|----------------------|
| The Authority | | Protected Place |
| | 44,227.138 | 30,914.221 |
| | 44,227.309 | 30,914.649 |
| | 44,227.401 | 30,915.093 |
| | 44,227.476 | 30,915.780 |
| | 44,227.498 | 30,916.489 |
| | 44,227.395 | 30,917.170 |
| | 44,227.093 | 30,917.760 |
| | 44,220.205 | 30,926.108 |
| | 44,220.929 | 30,926.702 |
| | 44,224.068 | 30,929.282 |
| | 44,224.791 | 30,929.877 |
| | 44,228.654 | 30,933.052 |
| | 44,232.517 | 30,936.226 |
| | 44,236.379 | 30,939.401 |
| | 44,240.242 | 30,942.576 |
| | 44,240.957 | 30,943.164 |
| | 44,244.104 | 30,945.751 |
| | 44,244.820 | 30,346.339 |
| | 44,247.978 | 30,948.911 |
| | 44,248.697 | 30,949.496 |
| | 44,251.855 | 30,952.068 |
| | 44,255.732 | 30,955.226 |
| | 44,259.609 | 30,958.383 |
| | 44,263.486 | 30,961.540 |
| | 44,267.363 | 30,964.698 |
| | 44,271.240 | 30,967.855 |
| | 44,275.117 | 30,971.012 |

to the point of commencement.

THE SCHEDULE — *continued*

| <i>First column</i> | <i>Second column</i> |
|---------------------|---------------------------------------------------------------------------------------------------------------|
| The Authority | Protected Place |
| | The boundaries of “LOWER SELETAR PUMPING STATION” are more particularly delineated in the Plan set out below. |

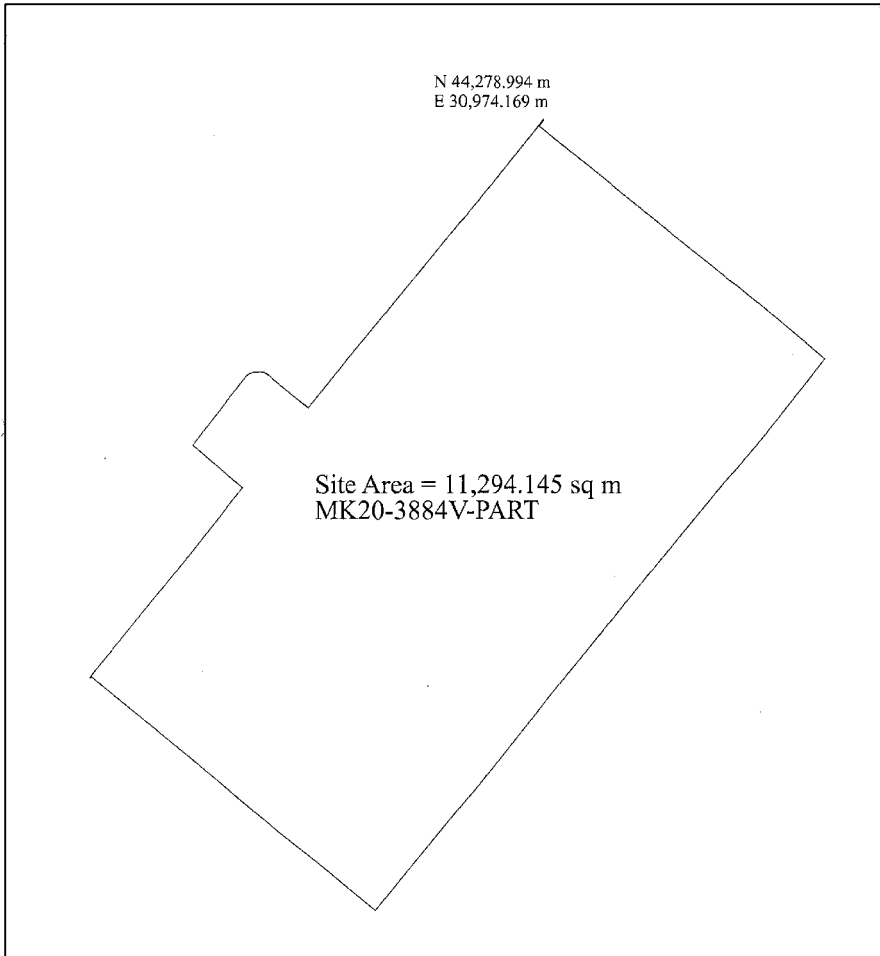

 THE SCHEDULE — *continued*

First column
The Authority

Second column
Protected Place

(10) UPPER SELETAR PUMPING STATION.

All that area comprised in part of State Land Lot MK14-1482K-PART, Track 7 off Mandai Road, occupied by “UPPER SELETAR PUMPING STATION” containing an area of about 5,810.467 square metres and bounded approximately as follows:

Commencing at the corner of the aforesaid “UPPER SELETAR PUMPING STATION” which point is 42,598.080 metres North and 25,243.114 metres East of the Singapore Land Authority SVY 21 Datum, the boundaries run along successive lines of co-ordinates approximately as follows:

| <i>Northings</i> | <i>Easting</i> |
|------------------|----------------|
| 42,564.269 | 25,261.056 |
| 42,550.492 | 25,268.392 |
| 42,543.136 | 25,266.447 |
| 42,512.715 | 25,283.046 |
| 42,506.744 | 25,272.229 |
| 42,503.720 | 25,266.887 |
| 42,492.733 | 25,246.778 |
| 42,491.112 | 25,243.492 |
| 42,490.351 | 25,242.693 |
| 42,487.824 | 25,237.634 |
| 42,508.042 | 25,219.824 |
| 42,524.801 | 25,207.687 |
| 42,555.184 | 25,186.804 |
| 42,566.006 | 25,191.309 |
| 42,571.862 | 25,198.496 |
| 42,582.505 | 25,216.251 |
| 42,595.181 | 25,237.817 |

to the point of commencement.

THE SCHEDULE — *continued*

First column
The Authority

Second column
Protected Place

The boundaries of “UPPER SELETAR PUMPING STATION” are more particularly delineated in the Plan set out below.

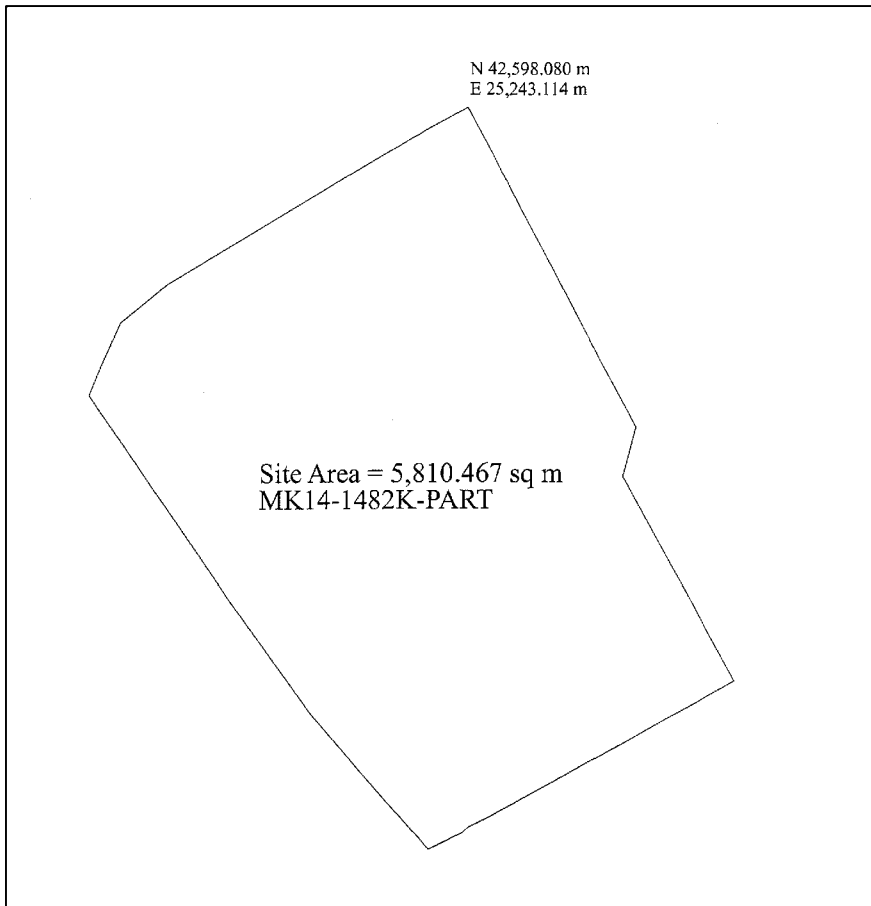

 THE SCHEDULE — *continued*

First column
The Authority

Second column
Protected Place

(11) TENGEH PUMPING STATION.

All that area comprised in part of State Land Lots MK07-3124T-PART, MK07-99927T-PART and MK07-99960P-PART, off Pasir Laba Road, occupied by “TENGEH PUMPING STATION” containing an area of about 4,581.907 square metres and bounded approximately as follows:

Commencing at the corner of the aforesaid “TENGEH PUMPING STATION” which point is 35,621.717 metres North and 8,977.987 metres East of the Singapore Land Authority SVY 21 Datum, the boundaries run along successive lines of co-ordinates approximately as follows:

| <i>Northings</i> | <i>Easting</i> |
|------------------|----------------|
| 35,619.541 | 9,009.259 |
| 35,618.143 | 9,029.351 |
| 35,615.388 | 9,075.245 |
| 35,607.954 | 9,078.209 |
| 35,600.239 | 9,077.765 |
| 35,600.416 | 9,074.945 |
| 35,584.442 | 9,074.247 |
| 35,577.897 | 9,073.975 |
| 35,553.408 | 9,072.377 |
| 35,554.725 | 9,052.449 |
| 35,566.476 | 9,037.771 |
| 35,578.616 | 9,026.459 |
| 35,582.664 | 8,991.039 |
| 35,592.395 | 8,975.934 |
| 35,615.671 | 8,977.640 |
| 35,616.707 | 8,977.716 |

to the point of commencement.

THE SCHEDULE — *continued*

| <i>First column</i> | <i>Second column</i> |
|---------------------|--------------------------------------------------------------------------------------------------------|
| The Authority | Protected Place |
| | The boundaries of “TENGEH PUMPING STATION” are more particularly delineated in the Plan set out below. |

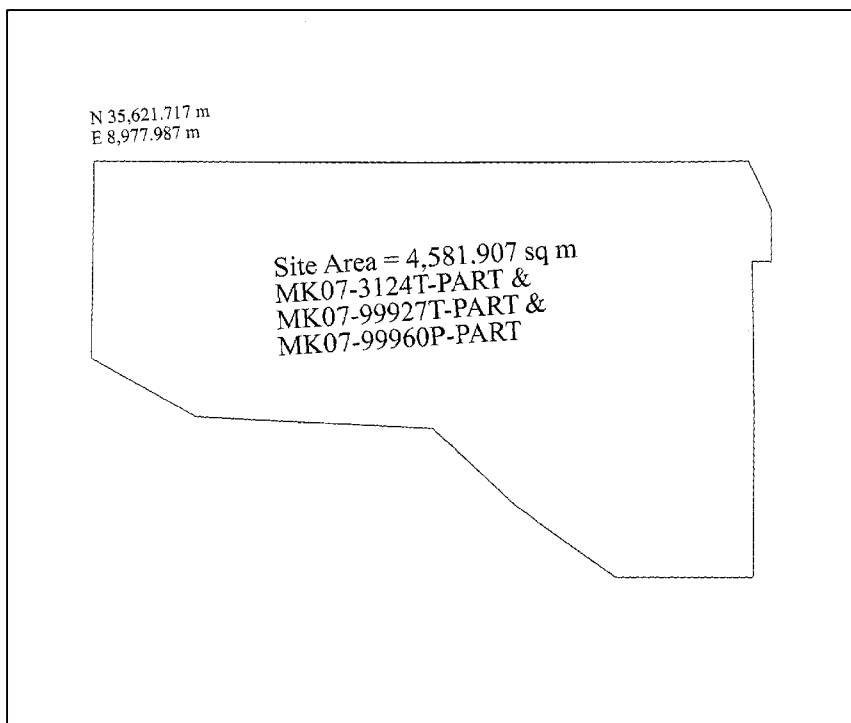

 THE SCHEDULE — *continued*

First column
The Authority

Second column
Protected Place

(12) JURONG PUMPING STATION.

All that area comprised in part of State Land Lot MK06-1783X-PART, off Yuan Ching Road, occupied by “JURONG PUMPING STATION” containing an area of about 1,425.337 square metres and bounded approximately as follows:

Commencing at the corner of the aforesaid “JURONG PUMPING STATION” which point is 36,296.412 metres North and 15,663.982 metres East of the Singapore Land Authority SVY 21 Datum, the boundaries run along successive lines of co-ordinates approximately as follows:

| <i>Northings</i> | <i>Easting</i> |
|------------------|----------------|
| 36,276.957 | 15,685.097 |
| 36,266.584 | 15,675.639 |
| 36,264.953 | 15,677.555 |
| 36,259.748 | 15,672.877 |
| 36,259.954 | 15,672.645 |
| 36,252.618 | 15,665.835 |
| 36,252.498 | 15,665.970 |
| 36,247.441 | 15,661.425 |
| 36,249.110 | 15,659.644 |
| 36,242.109 | 15,653.197 |
| 36,253.999 | 15,640.306 |
| 36,257.553 | 15,636.613 |
| 36,261.966 | 15,631.733 |

to the point of commencement.

THE SCHEDULE — *continued*

First column
The Authority

Second column
Protected Place

The boundaries of “JURONG PUMPING STATION” are more particularly delineated in the Plan set out below.

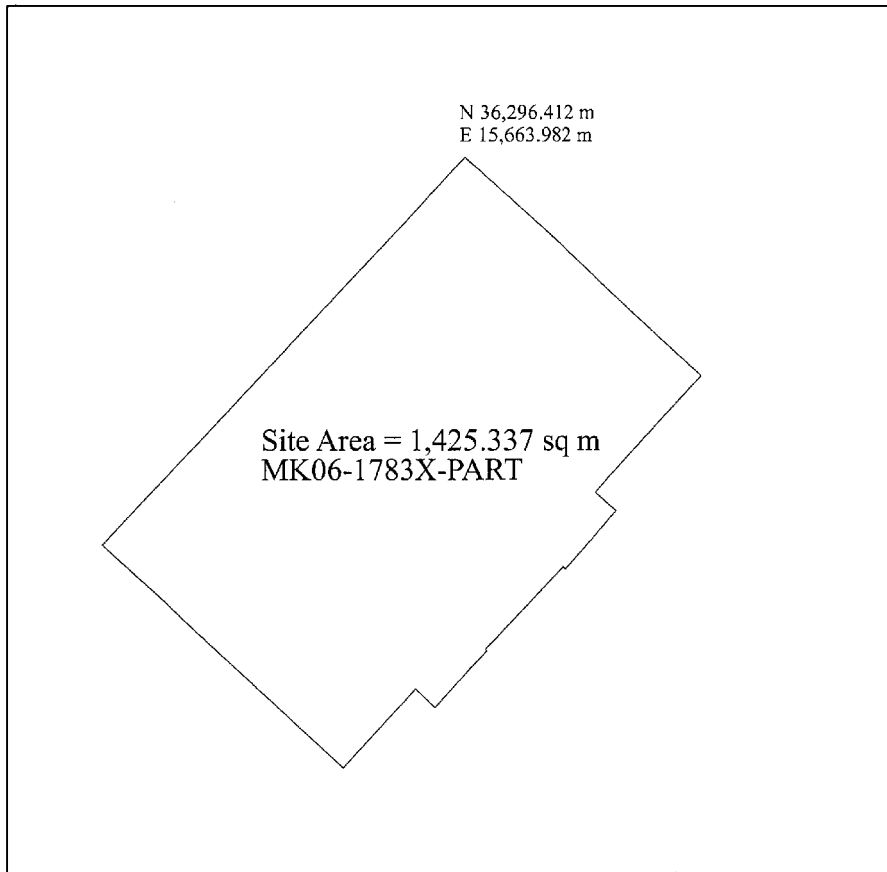

 THE SCHEDULE — *continued*

First column
The Authority

Second column
Protected Place

(13) WEST SELETAR PUMPING STATION.

All that area comprised in part of State Land Lot MK14-1482K-PART, Track 15 off Mandai Lake Road, occupied by “WEST SELETAR PUMPING STATION” containing an area of about 5,262.984 square metres and bounded approximately as follows:

Commencing at the corner of the aforesaid “WEST SELETAR PUMPING STATION” which point is 41,890.583 metres North and 22,456.414 metres East of the Singapore Land Authority SVY 21 Datum, the boundaries run along successive lines of co-ordinates approximately as follows:

| <i>Northings</i> | <i>Easting</i> |
|------------------|----------------|
| 41,885.395 | 22,471.540 |
| 41,857.646 | 22,462.159 |
| 41,831.819 | 22,533.139 |
| 41,858.745 | 22,542.756 |
| 41,848.944 | 22,571.615 |
| 41,826.425 | 22,562.487 |
| 41,820.732 | 22,561.921 |
| 41,820.264 | 22,561.783 |
| 41,820.057 | 22,562.287 |
| 41,818.473 | 22,561.742 |
| 41,797.317 | 22,621.807 |
| 41,782.580 | 22,616.445 |
| 41,790.020 | 22,595.164 |
| 41,798.325 | 22,598.183 |
| 41,812.063 | 22,559.180 |
| 41,811.766 | 22,558.992 |
| 41,812.823 | 22,555.901 |
| 41,771.090 | 22,519.686 |
| 41,775.619 | 22,512.722 |
| 41,783.486 | 22,499.592 |
| 41,790.512 | 22,504.090 |

THE SCHEDULE — *continued*

| <i>First column</i> | <i>Second column</i> | |
|---------------------|----------------------|------------|
| The Authority | Protected Place | |
| | 41,792.875 | 22,500.247 |
| | 41,819.204 | 22,517.750 |
| | 41,839.179 | 22,466.987 |
| | 41,841.856 | 22,461.011 |
| | 41,843.650 | 22,457.010 |
| | 41,845.444 | 22,453.008 |
| | 41,850.842 | 22,442.031 |

to the point of commencement.

The boundaries of “WEST SELETAR PUMPING STATION” are more particularly delineated in the Plan set out below.

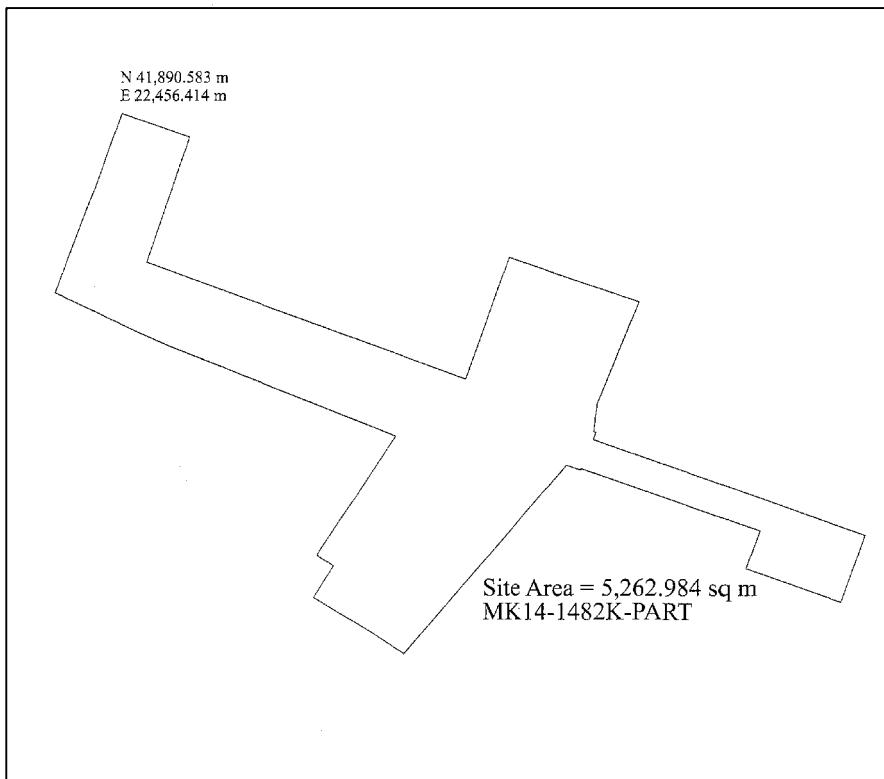

Made this 18th day of January 2006.

BENNY LIM
*Permanent Secretary,
Ministry of Home Affairs,
Singapore.*

[CP/C/198/39/1; MHA (PS) 12/2/02 TF 1;
AG/LEG/SL/256/2002/1 Vol. 7]