First published in the *Government Gazette*, Electronic Edition, on 25th January 2006 at 5:00 pm.

No. S 42

**PROTECTED AREAS AND PROTECTED PLACES ACT
(CHAPTER 256)**

**PROTECTED PLACES (NO. 3)
ORDER 2006**

ARRANGEMENT OF PARAGRAPHS

Paragraph

1. Citation and commencement
 2. Premises declared to be protected places
- The Schedule
-

In exercise of the powers conferred by section 5 (1) of the Protected Areas and Protected Places Act, the Minister for Home Affairs hereby makes the following Order:

Citation and commencement

1. This Order may be cited as the Protected Places (No. 3) Order 2006 and shall come into operation on 25th January 2006.

Premises declared to be protected places

2. The premises described in the second column of the Schedule are hereby declared to be protected places for the purposes of the Act, and no person shall be in those premises unless he is in possession of a pass-card or permit issued by the authority specified in the first column of the Schedule or has received the permission of an authorised officer on duty at the premises to enter the premises.

 THE SCHEDULE

First column
 The Authority
 Director,
 3P Network Department

Second column
 Protected Place

(1) KRANJI TIDAL GATES.

All that area comprised in part of State Land Lot MK12-868X-PART, off Kranji Way, occupied by “KRANJI TIDAL GATES” containing an area of about 3,011.680 square metres and bounded approximately as follows:

Commencing at the corner of the aforesaid “KRANJI TIDAL GATES” which point is 46,726.975 metres North and 17,233.676 metres East of the Singapore Land Authority SVY 21 Datum, the boundaries run along successive lines of co-ordinates approximately as follows:

<i>Northings</i>	<i>Easting</i>
46,726.886	17,287.745
46,726.753	17,290.762
46,716.030	17,291.020
46,716.039	17,297.419
46,716.095	17,300.063
46,715.926	17,306.325
46,714.677	17,306.298
46,700.877	17,306.015
46,700.912	17,228.232
46,700.879	17,226.935
46,700.900	17,149.942
46,710.770	17,149.839
46,715.730	17,149.667
46,715.955	17,230.260
46,726.745	17,230.266

to the point of commencement.

THE SCHEDULE — *continued*

First column
The Authority

Second column
Protected Place

The boundaries of “KRANJI TIDAL GATES” are more particularly delineated in the Plan set out below.

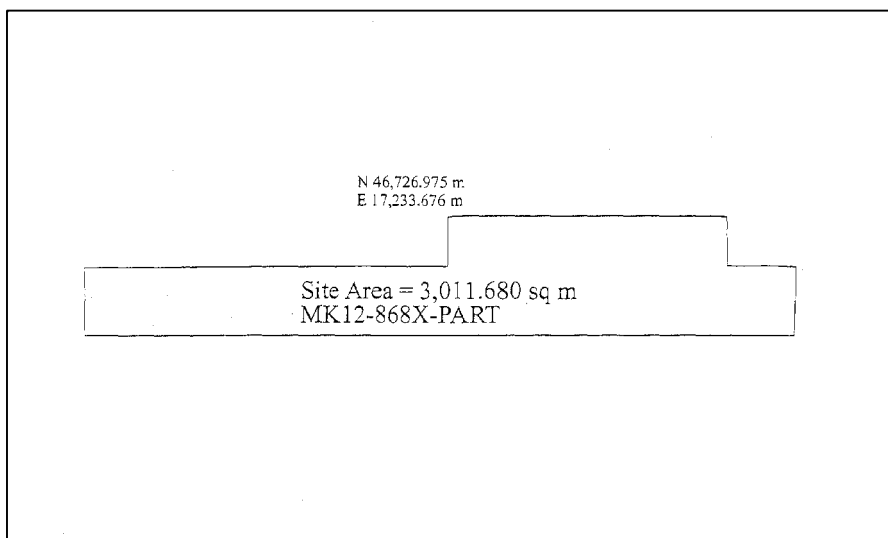

 THE SCHEDULE — *continued*

First column
The Authority

Second column
Protected Place

(2) PANDAN TIDAL GATES.

All that area comprised in part of State Land Lot MK05-7449T-PART, off West Coast Road, occupied by “PANDAN TIDAL GATES” containing an area of about 5,040.052 square metres and bounded approximately as follows:

Commencing at the corner of the aforesaid “PANDAN TIDAL GATES” which point is 32,728.496 metres North and 18,376.220 metres East of the Singapore Land Authority SVY 21 Datum, the boundaries run along successive lines of co-ordinates approximately as follows:

<i>Northings</i>	<i>Easting</i>
32,712.924	18,377.432
32,715.812	18,414.331
32,717.517	18,414.182
32,718.906	18,414.125
32,720.434	18,414.307
32,721.881	18,414.730
32,723.257	18,415.407
32,723.452	18,415.545
32,724.531	18,416.312
32,725.634	18,417.411
32,726.498	18,418.673
32,727.028	18,420.064
32,727.261	18,421.561
32,727.344	18,422.593
32,727.300	18,423.316
32,727.255	18,424.039
32,727.027	18,425.498
32,726.496	18,426.889
32,725.632	18,428.151
32,724.528	18,429.528
32,723.254	18,430.154

THE SCHEDULE — *continued*

<i>First column</i>		<i>Second column</i>
The Authority		Protected Place
	32,721.878	18,430.830
	32,720.431	18,431.253
	32,718.903	18,431.434
	32,717.239	18,431.579
	32,720.645	18,474.293
	32,717.156	18,474.574
	32,710.617	18,475.019
	32,706.848	18,475.332
	32,705.715	18,462.217
	32,680.136	18,464.204
	32,674.657	18,464.646
	32,668.019	18,464.740
	32,667.782	18,462.002
	32,665.427	18,432.659
	32,665.365	18,432.608
	32,665.004	18,432.240
	32,664.643	18,431.872
	32,664.002	18,431.066
	32,663.453	18,430.203
	32,663.166	18,429.533
	32,662.995	18,428.818
	32,662.903	18,428.085
	32,662.850	18,427.356
	32,662.818	18,426.628
	32,662.830	18,425.891
	32,662.911	18,425.161
	32,663.090	18,424.455
	32,663.472	18,423.477
	32,663.935	18,422.535
	32,664.347	18,421.843
	32,664.535	18,421.539

THE SCHEDULE — *continued*

<i>First column</i>	<i>Second column</i>	
The Authority	Protected Place	
	32,661.374	18,382.150
	32,661.146	18,378.754
	32,667.703	18,378.251
	32,692.718	18,376.115
	32,692.495	18,372.122
	32,708.987	18,370.514
	32,721.624	18,369.370
	32,727.755	18,369.063

to the point of commencement.

The boundaries of “PANDAN TIDAL GATES” are more particularly delineated in the Plan set out below.

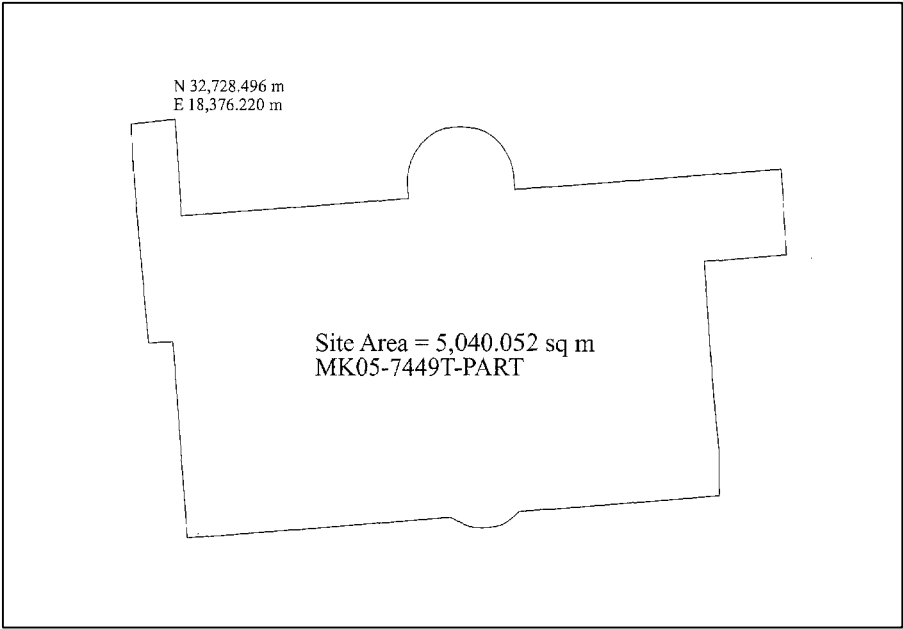

 THE SCHEDULE — *continued*

First column
The Authority

Second column
Protected Place

(3) LOWER SELETAR TIDAL GATES.

All that area comprised in part of State Land Lots MK19-1179L-PART, MK19-1181X-PART, MK19-2592V-PART, MK19-2595A-PART and MK19-2602V-PART, Yishun Avenue 1, occupied by “LOWER SELETAR TIDAL GATES” containing an area of about 2,161.820 square metres and bounded approximately as follows:

Commencing at the corner of the aforesaid “LOWER SELETAR TIDAL GATES” which point is 45,211.872 metres North and 30,665.219 metres East of the Singapore Land Authority SVY 21 Datum, the boundaries run along successive lines of co-ordinates approximately as follows:

<i>Northing</i>	<i>Easting</i>
45,209.730	30,670.057
45,180.388	30,732.697
45,178.265	30,737.306
45,170.023	30,754.935
45,167.899	30,759.510
45,167.258	30,760.785
45,144.169	30,750.191
45,159.964	30,717.456
45,169.168	30,721.729
45,189.794	30,677.219
45,180.357	30,672.977
45,188.648	30,654.455
45,188.648	30,654.455

to the point of commencement.

THE SCHEDULE — *continued*

First column
The Authority

Second column
Protected Place

The boundaries of “LOWER SELETAR TIDAL GATES” are more particularly delineated in the Plan set out below.

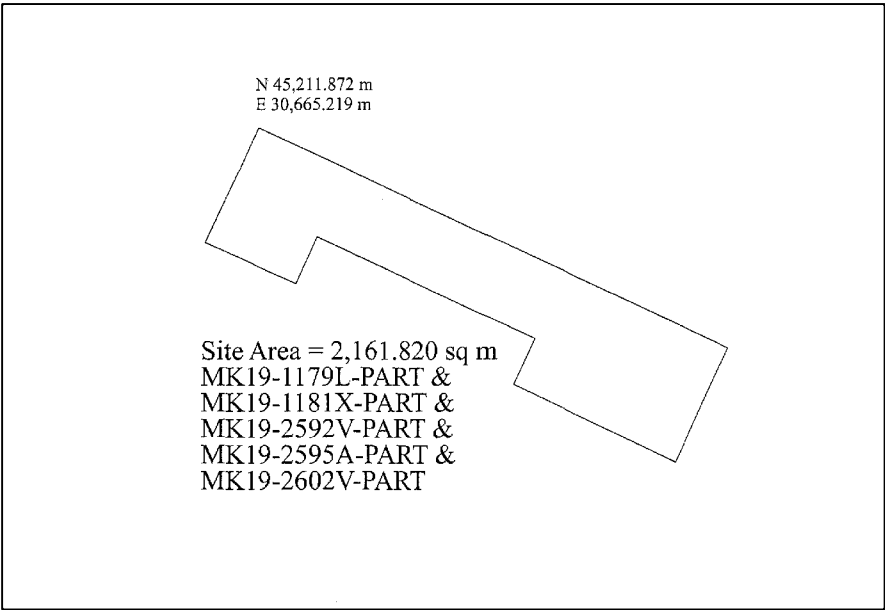

 THE SCHEDULE — *continued*

<i>First column</i>	<i>Second column</i>
The Authority	Protected Place

(4) JURONG TIDAL GATES.

All that area comprised in part of State Land Lots MK05-6466K-PART, MK05-7460L-PART, MK06-1591X-PART and MK06-3595X-PART, off Ayer Rajah Expressway, occupied by “JURONG TIDAL GATES” containing an area of about 3,136.845 square metres and bounded approximately as follows:

Commencing at the corner of the aforesaid “JURONG TIDAL GATES” which point is 34,390.950 metres North and 16,890.249 metres East of the Singapore Land Authority SVY 21 Datum, the boundaries run along successive lines of co-ordinates approximately as follows:

<i>Northing</i>	<i>Easting</i>
34,380.480	16,901.129
34,373.383	16,906.620
34,361.616	16,912.525
34,355.915	16,888.448
34,354.754	16,885.403
34,353.439	16,882.794
34,352.038	16,876.501
34,349.238	16,876.601
34,347.269	16,876.201
34,345.564	16,875.355
34,344.160	16,874.241
34,342.811	16,872.781
34,341.517	16,867.250
34,332.538	16,827.985
34,331.776	16,823.591
34,332.066	16,821.542
34,332.282	16,819.560
34,332.839	16,817.991
34,333.869	16,816.496

THE SCHEDULE — *continued*

<i>First column</i>		<i>Second column</i>
The Authority		Protected Place
	34,335.452	16,815.226
	34,336.787	16,814.504
	34,336.449	16,813.375
	34,335.433	16,808.491
	34,334.774	16,805.909
	34,331.920	16,791.166
	34,328.219	16,773.696
	34,337.112	16,771.357
	34,337.608	16,771.016
	34,340.821	16,774.293
	34,343.331	16,776.280
	34,348.170	16,780.281
	34,351.310	16,783.780
	34,352.931	16,786.539
	34,354.519	16,791.069
	34,355.236	16,794.192
	34,355.391	16,797.106
	34,355.914	16,801.787
	34,358.666	16,818.086
	34,358.502	16,820.324
	34,357.926	16,821.699
	34,356.877	16,822.857
	34,355.436	16,823.574
	34,355.110	16,823.647
	34,355.198	16,824.045
	34,352.963	16,824.538
	34,361.282	16,861.552
	34,363.443	16,861.076
	34,363.425	16,860.993
	34,364.086	16,860.845
	34,365.529	16,860.915

THE SCHEDULE — *continued*

<i>First column</i>	<i>Second column</i>	
The Authority	Protected Place	
	34,367.115	16,861.401
	34,368.356	16,862.165
	34,369.234	16,863.485
	34,372.096	16,874.262
	34,372.754	16,875.827
	34,373.569	16,877.097
	34,374.773	16,878.252
	34,380.199	16,882.388
	34,382.438	16,884.188

to the point of commencement.

The boundaries of “JURONG TIDAL GATES” are more particularly delineated in the Plan set out below.

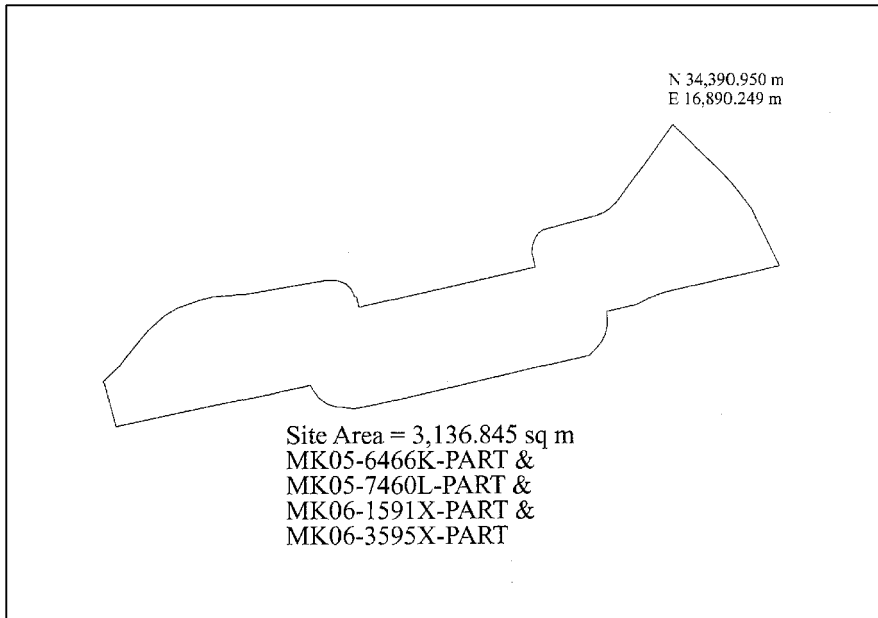

 THE SCHEDULE — *continued*

First column
The Authority

Second column
Protected Place

(5) POYAN TIDAL GATES.

All that area comprised in part of State Land Lot MK12-1500L-PART, occupied by “POYAN TIDAL GATES” containing an area of about 1,532.490 square metres and bounded approximately as follows:

Commencing at the corner of the aforesaid “POYAN TIDAL GATES” which point is 40,646.912 metres North and 8,449.925 metres East of the Singapore Land Authority SVY 21 Datum, the boundaries run along successive lines of co-ordinates approximately as follows:

<i>Northings</i>	<i>Easting</i>
40,644.819	8,454.241
40,642.391	8,458.909
40,633.339	8,476.940
40,609.936	8,465.434
40,603.452	8,446.674
40,598.094	8,443.827
40,588.535	8,438.023
40,586.265	8,436.995
40,580.068	8,434.142
40,586.779	8,420.432
40,594.637	8,424.285
40,603.641	8,428.701
40,612.651	8,433.104
40,623.576	8,438.438
40,624.729	8,438.988
40,631.616	8,442.383

to the point of commencement.

THE SCHEDULE — *continued*

First column
The Authority

Second column
Protected Place

The boundaries of “POYAN TIDAL GATES” are more particularly delineated in the Plan set out below.

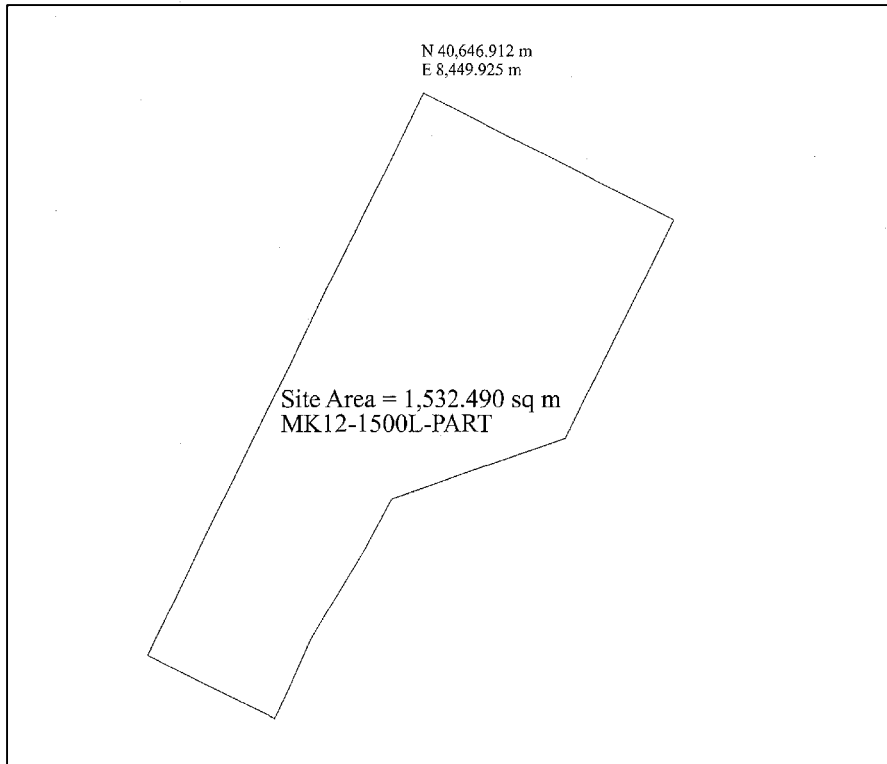

Made this 18th day of January 2006.

BENNY LIM
*Permanent Secretary,
Ministry of Home Affairs,
Singapore.*

[CP/C/198/39/1; MHA (PS) 12/2/02 TF 1;
AG/LEG/SL/256/2002/1 Vol. 7]