First published in the *Government Gazette*, Electronic Edition, on 25th January 2006 at 5:00 pm.

No. S 43

**PROTECTED AREAS AND PROTECTED PLACES ACT
(CHAPTER 256)**

**PROTECTED PLACES (NO. 4)
ORDER 2006**

ARRANGEMENT OF PARAGRAPHS

Paragraph

1. Citation and commencement
2. Premises declared to be protected places

The Schedule

In exercise of the powers conferred by section 5 (1) of the Protected Areas and Protected Places Act, the Minister for Home Affairs hereby makes the following Order:

Citation and commencement

1. This Order may be cited as the Protected Places (No. 4) Order 2006 and shall come into operation on 25th January 2006.

Premises declared to be protected places

2. The premises described in the second column of the Schedule are hereby declared to be protected places for the purposes of the Act, and no person shall be in those premises unless he is in possession of a pass-card or permit issued by the authority specified in the first column of the Schedule or has received the permission of an authorised officer on duty at the premises to enter the premises.

 THE SCHEDULE

<i>First column</i>	<i>Second column</i>																																										
The Authority	Protected Place																																										
Director, Water Supply (Network) Department	<p>(1) ISLAND SERVICE RESERVOIR.</p> <p>All that area comprised in part of State Land Lots MK15-2505T-PART and MK15-2506A-PART, off Old Upper Thomson Road, occupied by “ISLAND SERVICE RESERVOIR” containing an area of about 72,328.237 square metres and bounded approximately as follows:</p> <p>Commencing at the corner of the aforesaid “ISLAND SERVICE RESERVOIR” which point is 39,865.834 metres North and 24,576.111 metres East of the Singapore Land Authority SVY 21 Datum, the boundaries run along successive lines of co-ordinates approximately as follows:</p> <table> <tr> <th><i>Northing</i></th><th><i>Easting</i></th></tr> <tr><td>39,850.901</td><td>24,605.677</td></tr> <tr><td>39,717.397</td><td>24,608.423</td></tr> <tr><td>39,651.840</td><td>24,614.105</td></tr> <tr><td>39,625.592</td><td>24,641.153</td></tr> <tr><td>39,602.418</td><td>24,721.476</td></tr> <tr><td>39,617.638</td><td>24,754.112</td></tr> <tr><td>39,621.194</td><td>24,767.496</td></tr> <tr><td>39,621.238</td><td>24,779.230</td></tr> <tr><td>39,617.169</td><td>24,797.151</td></tr> <tr><td>39,601.958</td><td>24,829.697</td></tr> <tr><td>39,591.386</td><td>24,841.654</td></tr> <tr><td>39,574.913</td><td>24,848.138</td></tr> <tr><td>39,557.509</td><td>24,847.533</td></tr> <tr><td>39,535.310</td><td>24,843.307</td></tr> <tr><td>39,516.658</td><td>24,831.794</td></tr> <tr><td>39,502.026</td><td>24,812.938</td></tr> <tr><td>39,492.532</td><td>24,784.775</td></tr> <tr><td>39,494.208</td><td>24,761.983</td></tr> <tr><td>39,500.028</td><td>24,745.901</td></tr> <tr><td>39,515.920</td><td>24,728.130</td></tr> </table>	<i>Northing</i>	<i>Easting</i>	39,850.901	24,605.677	39,717.397	24,608.423	39,651.840	24,614.105	39,625.592	24,641.153	39,602.418	24,721.476	39,617.638	24,754.112	39,621.194	24,767.496	39,621.238	24,779.230	39,617.169	24,797.151	39,601.958	24,829.697	39,591.386	24,841.654	39,574.913	24,848.138	39,557.509	24,847.533	39,535.310	24,843.307	39,516.658	24,831.794	39,502.026	24,812.938	39,492.532	24,784.775	39,494.208	24,761.983	39,500.028	24,745.901	39,515.920	24,728.130
<i>Northing</i>	<i>Easting</i>																																										
39,850.901	24,605.677																																										
39,717.397	24,608.423																																										
39,651.840	24,614.105																																										
39,625.592	24,641.153																																										
39,602.418	24,721.476																																										
39,617.638	24,754.112																																										
39,621.194	24,767.496																																										
39,621.238	24,779.230																																										
39,617.169	24,797.151																																										
39,601.958	24,829.697																																										
39,591.386	24,841.654																																										
39,574.913	24,848.138																																										
39,557.509	24,847.533																																										
39,535.310	24,843.307																																										
39,516.658	24,831.794																																										
39,502.026	24,812.938																																										
39,492.532	24,784.775																																										
39,494.208	24,761.983																																										
39,500.028	24,745.901																																										
39,515.920	24,728.130																																										

THE SCHEDULE — *continued*

<i>First column</i>		<i>Second column</i>
The Authority		Protected Place
	39,526.208	24,722.652
	39,533.104	24,706.349
	39,534.076	24,692.748
	39,545.742	24,654.433
	39,497.899	24,579.258
	39,505.796	24,566.436
	39,515.563	24,528.211
	39,624.216	24,500.202
	39,673.370	24,437.891
	39,695.091	24,417.933
	39,712.646	24,408.410
	39,731.924	24,404.621
	39,761.082	24,406.921
	39,783.869	24,424.033
	39,792.910	24,437.918
	39,796.965	24,444.121
	39,801.852	24,461.589
	39,854.835	24,517.550
	39,862.076	24,546.347

to the point of commencement.

THE SCHEDULE — *continued*

First column
The Authority

Second column
Protected Place

The boundaries of “ISLAND SERVICE RESERVOIR” are more particularly delineated in the Plan set out below.

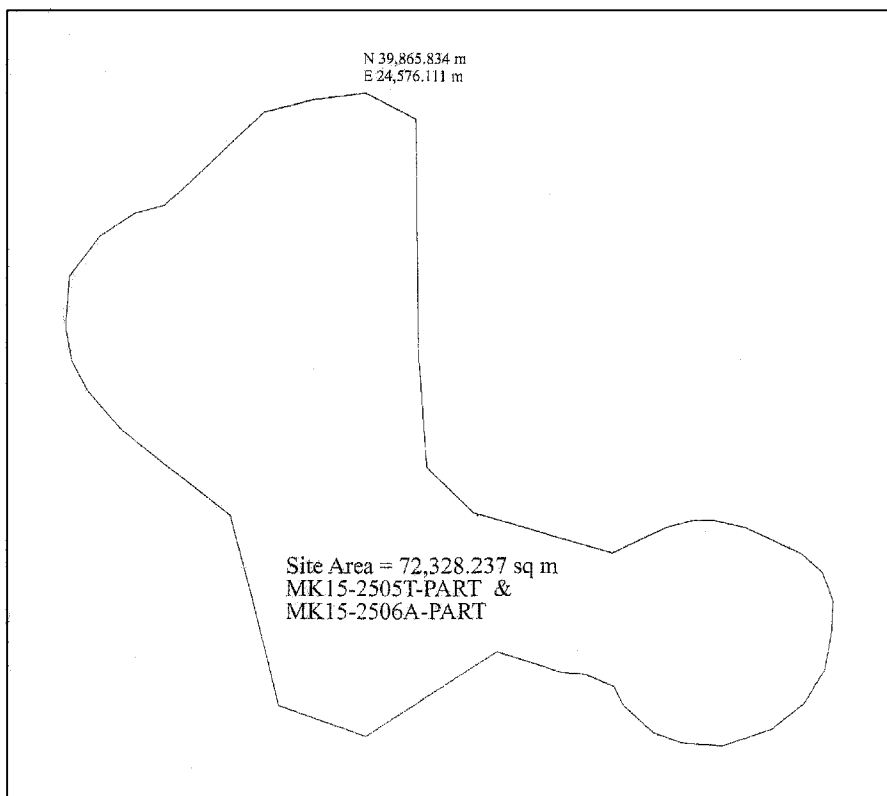

 THE SCHEDULE — *continued*

<i>First column</i>	<i>Second column</i>
The Authority	Protected Place
	(2) LORONG ASRAMA SERVICE RESERVOIR.
	All that area comprised in part of State Land Lot MK13-1437X-PART, end of Lorong Asrama, occupied by “LORONG ASRAMA SERVICE RESERVOIR” containing an area of about 60,459.321 square metres and bounded approximately as follows:
	Commencing at the corner of the aforesaid “LORONG ASRAMA SERVICE RESERVOIR” which point is 44,739.002 metres North and 22,179.583 metres East of the Singapore Land Authority SVY 21 Datum, the boundaries run along successive lines of co-ordinates approximately as follows:
<i>Northing</i>	<i>Easting</i>
44,553.571	22,340.606
44,531.316	22,338.876
44,481.250	22,293.949
44,461.674	22,276.382
44,477.352	22,160.258
44,348.055	22,044.102
44,419.447	21,964.489
44,421.357	21,962.360
44,438.156	21,975.269
44,621.881	22,118.580
44,664.607	22,151.907
44,683.228	22,166.449
44,698.725	22,177.928
44,720.616	22,158.921
44,732.649	22,172.444
	to the point of commencement.

THE SCHEDULE — *continued*

First column
The Authority

Second column
Protected Place

The boundaries of “LORONG ASRAMA SERVICE RESERVOIR” are more particularly delineated in the Plan set out below.

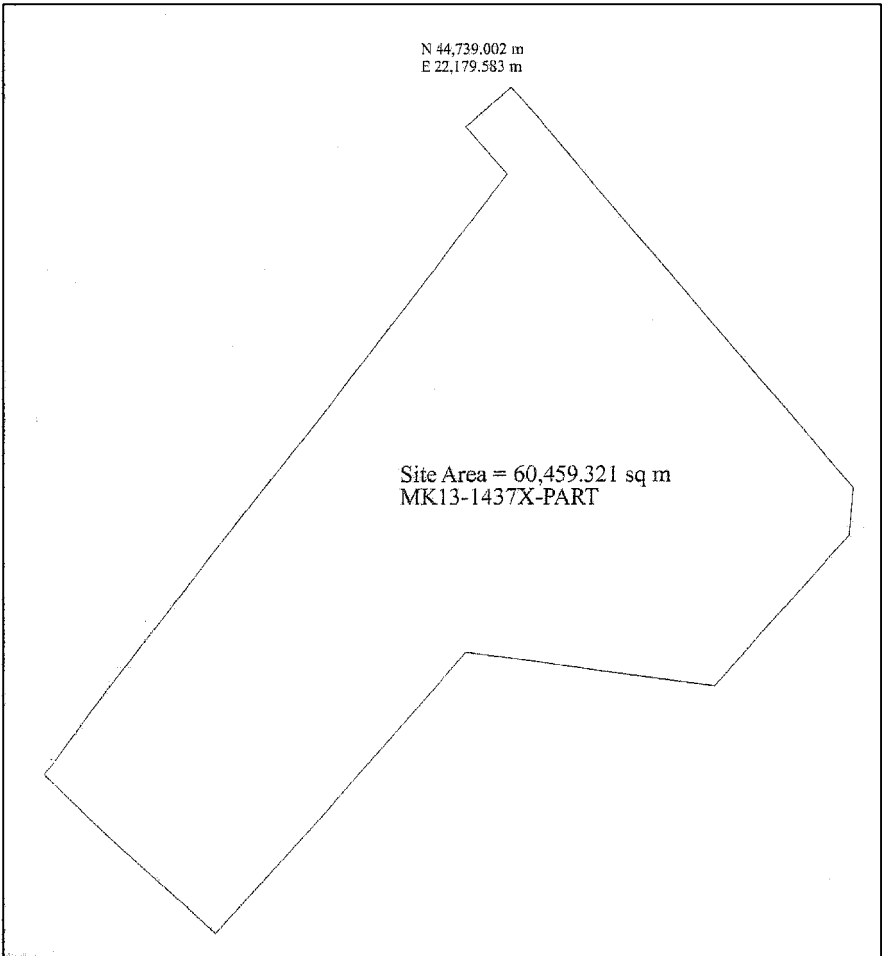

 THE SCHEDULE — *continued*

First column
The Authority

Second column
Protected Place

(3) BUKIT KALANG SERVICE RESERVOIR.

All that area comprised in part of State Land Lots MK15-2505T-PART, MK15-2506A-PART and MK17-5941W-PART, end of Island Club Road, occupied by “BUKIT KALANG SERVICE RESERVOIR” containing an area of about 63,501.198 square metres and bounded approximately as follows:

Commencing at the corner of the aforesaid “BUKIT KALANG SERVICE RESERVOIR” which point is 37,882.240 metres North and 25,781.359 metres East of the Singapore Land Authority SVY 21 Datum, the boundaries run along successive lines of co-ordinates approximately as follows:

<i>Northing</i>	<i>Easting</i>
37,874.129	25,802.568
37,716.727	25,934.475
37,718.198	25,937.177
37,766.857	25,026.504
37,729.608	25,041.176
37,673.895	25,069.986
37,649.661	25,086.873
37,624.386	25,095.422
37,590.436	25,091.852
37,582.343	25,075.810
37,572.720	25,999.421
37,570.140	25,991.057
37,569.508	25,985.388
37,570.868	25,982.846
37,572.418	25,952.805
37,583.481	25,926.313
37,579.092	25,921.148
37,569.479	25,909.834
37,593.978	25,884.212

THE SCHEDULE — *continued*

<i>First column</i>	<i>Second column</i>	
The Authority	Protected Place	
	37,625.386	25,840.765
	37,695.384	25,781.311
	37,701.852	25,775.818
	37,701.145	25,762.572
	37,726.437	25,732.413
	37,763.706	25,700.510
	37,767.618	25,697.208
	37,798.349	25,671.267
	37,877.602	25,765.629
	37,880.423	25,770.935
	37,882.141	25,776.510

to the point of commencement.

The boundaries of “BUKIT KALANG SERVICE RESERVOIR” are more particularly delineated in the Plan set out below.

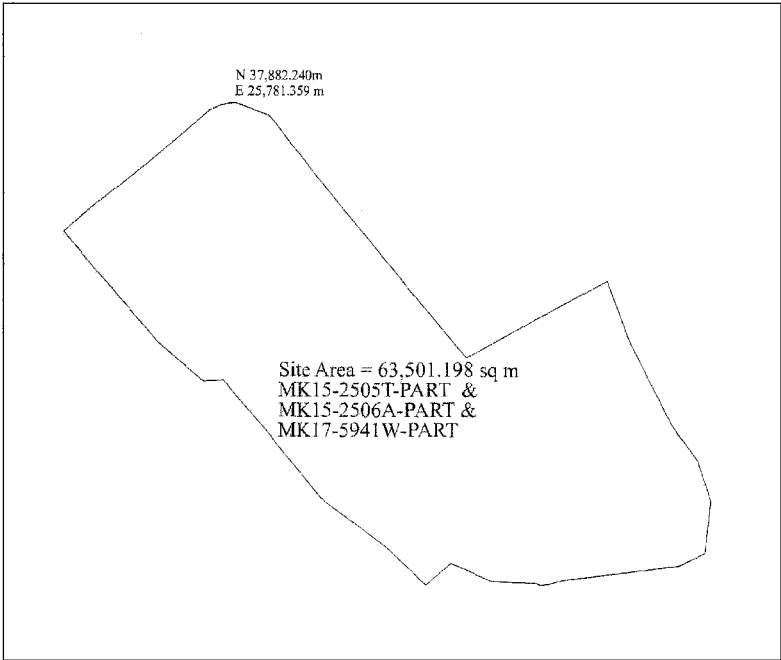

 THE SCHEDULE — *continued*

First column
The Authority

Second column
Protected Place

(4) MURNANE SERVICE RESERVOIR.

All that area comprised in part of State Land Lots MK16-87A-PART, MK16-2042W-PART and MK16-99531X-PART, off Jalan Kampong Chantek, occupied by “MURNANE SERVICE RESERVOIR” containing an area of about 94,574.736 square metres and bounded approximately as follows:

Commencing at the corner of the aforesaid “MURNANE SERVICE RESERVOIR” which point is 37,271.609 metres North and 22,686.641 metres East of the Singapore Land Authority SVY 21 Datum, the boundaries run along successive lines of co-ordinates approximately as follows:

<i>Northing</i>	<i>Easting</i>
37,261.297	22,694.934
37,263.512	22,705.913
37,233.285	22,718.001
37,235.542	22,727.183
37,234.299	22,752.339
36,928.199	22,907.187
36,823.127	22,889.047
36,819.981	22,879.537
36,800.926	22,848.852
36,787.061	22,833.010
36,778.841	22,817.618
36,769.321	22,814.165
36,743.970	22,753.673
36,760.340	22,743.625
36,764.731	22,742.110
36,764.369	22,731.240
36,911.958	22,658.342
36,915.441	22,665.088
36,940.009	22,653.253

 THE SCHEDULE — *continued*

<i>First column</i>		<i>Second column</i>
The Authority		Protected Place
	36,947.192	22,652.154
	36,949.353	22,641.973
	36,964.049	22,645.285
	36,966.688	22,643.553
	36,975.423	22,645.498
	36,976.390	22,647.990
	36,985.059	22,649.933
	36,993.980	22,651.933
	37,002.625	22,653.501
	37,014.564	22,653.753
	37,026.327	22,651.386
	37,040.456	22,646.132
	37,046.764	22,639.565
	37,068.715	22,624.151
	37,072.970	22,629.583
	37,091.966	22,616.409
	37,102.198	22,622.964
	37,171.452	22,597.860
	37,188.836	22,609.645
	37,196.033	22,604.026
	37,211.810	22,624.679
	37,225.688	22,623.724
	37,247.278	22,641.094
	37,256.218	22,653.350
	37,257.621	22,655.536
	37,260.905	22,659.387

to the point of commencement.

THE SCHEDULE — *continued*

First column
The Authority

Second column
Protected Place

The boundaries of “MURNANE SERVICE RESERVOIR” are more particularly delineated in the Plan set out below.

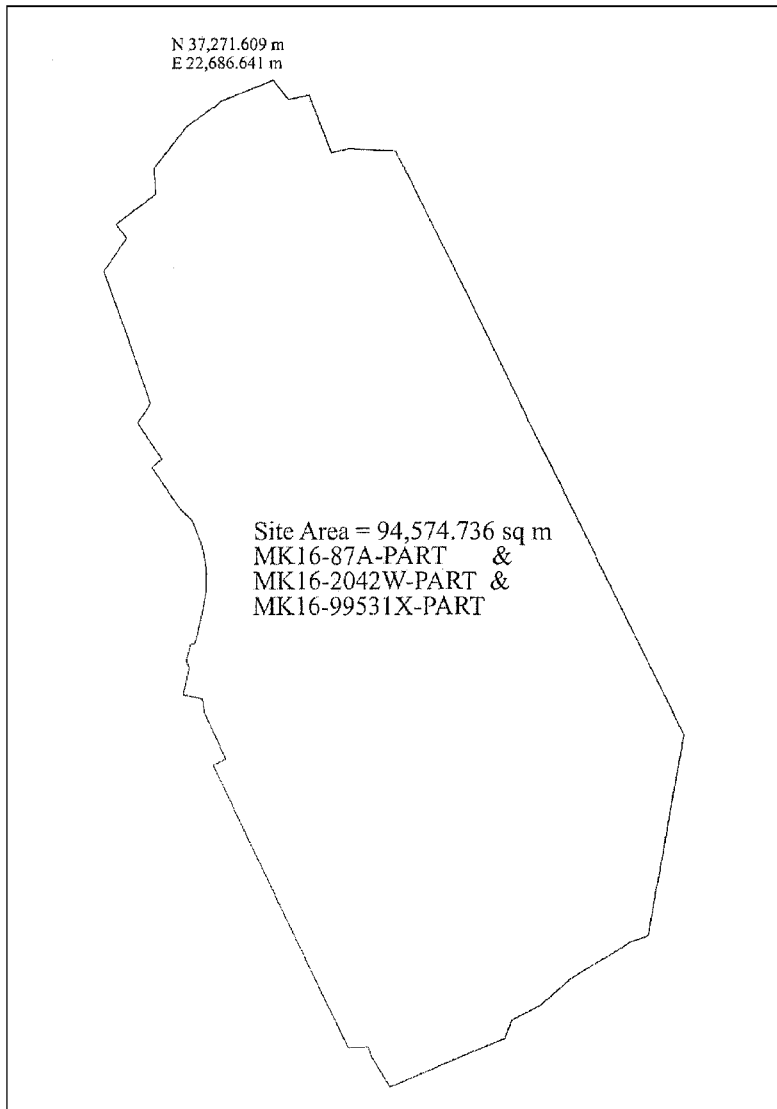

 THE SCHEDULE — *continued*

First column
The Authority

Second column
Protected Place

(5) NANYANG SERVICE RESERVOIR.

All that area comprised in part of State Land Lot MK09-366P-PART, off Nanyang Walk, occupied by “NANYANG SERVICE RESERVOIR” containing an area of about 28,718.604 square metres and bounded approximately as follows:

Commencing at the corner of the aforesaid “NANYANG SERVICE RESERVOIR” which point is 37,300.391 metres North and 11,443.558 metres East of the Singapore Land Authority SVY 21 Datum, the boundaries run along successive lines of co-ordinates approximately as follows:

<i>Northings</i>	<i>Easting</i>
37,289.018	11,474.800
37,270.992	11,483.189
37,257.104	11,483.803
37,171.195	11,406.674
37,125.952	11,409.211
37,109.904	11,417.981
37,080.137	11,449.642
37,054.038	11,447.147
36,994.451	11,391.056
37,022.770	11,361.496
37,022.550	11,359.963
37,020.052	11,351.383
37,029.866	11,344.742
37,025.416	11,338.972
36,997.843	11,351.504
36,992.168	11,349.699
36,968.274	11,329.551
36,965.897	11,327.104
36,964.535	11,324.175
36,956.542	11,249.683
36,949.481	11,223.518

THE SCHEDULE — *continued*

<i>First column</i>	<i>Second column</i>	
The Authority	Protected Place	
	37,027.266	11,217.011
	37,034.788	11,218.361
	37,046.849	11,332.897
	37,049.967	11,340.906
	37,094.847	11,375.613
	37,112.645	11,376.804
	37,114.025	11,379.707
	37,135.725	11,382.607
	37,140.125	11,379.107
	37,146.534	11,378.124
	37,166.698	11,365.006
	37,187.273	11,342.055

to the point of commencement.

The boundaries of “NANYANG SERVICE RESERVOIR” are more particularly delineated in the Plan set out below.

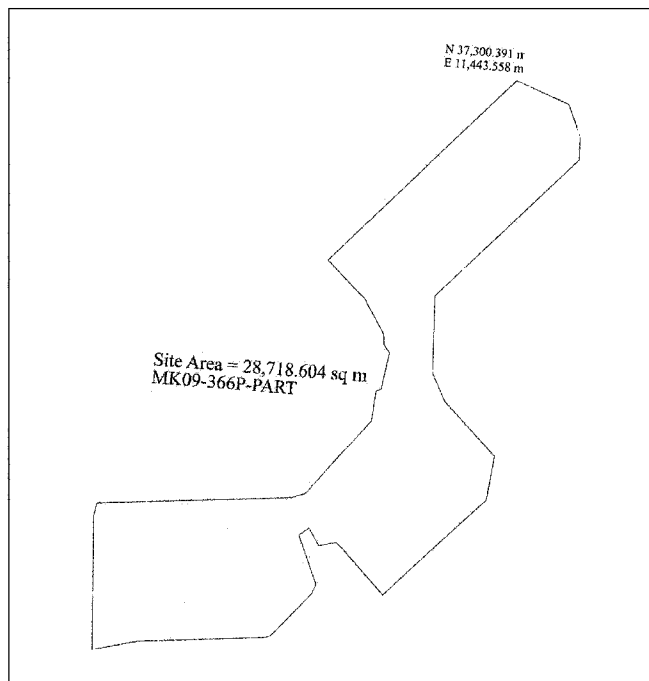

 THE SCHEDULE — *continued*

First column
The Authority

Second column
Protected Place

(6) FORT CANNING SERVICE RESERVOIR.

All that area comprised in part of State Land Lot TS20-99443W-PART, Cox Terrace, Fort Canning Park, occupied by “FORT CANNING SERVICE RESERVOIR” containing an area of about 27,869.131 square metres and bounded approximately as follows:

Commencing at the corner of the aforesaid “FORT CANNING SERVICE RESERVOIR” which point is 30,783.800 metres North and 29,440.719 metres East of the Singapore Land Authority SVY 21 Datum, the boundaries run along successive lines of co-ordinates approximately as follows:

<i>Northings</i>	<i>Easting</i>
30,760.656	29,519.811
30,751.266	29,525.270
30,745.166	29,531.929
30,736.514	29,535.363
30,728.670	29,534.607
30,719.373	29,537.709
30,709.118	29,541.103
30,708.019	29,541.958
30,681.690	29,557.233
30,672.289	29,559.319
30,666.435	29,553.178
30,658.550	29,544.905
30,658.282	29,544.624
30,564.793	29,568.346
30,538.159	29,539.394
30,532.803	29,533.054
30,533.564	29,526.959
30,532.732	29,523.748
30,529.892	29,518.606
30,528.098	29,516.560

THE SCHEDULE — *continued*

<i>First column</i>		<i>Second column</i>
The Authority		Protected Place
	30,522.958	29,510.701
	30,523.001	29,509.461
	30,527.945	29,492.944
	30,535.594	29,473.985
	30,625.695	29,455.188
	30,628.222	29,451.530
	30,640.611	29,420.347
	30,652.424	29,418.720
	30,652.966	29,418.569
	30,658.958	29,416.909
	30,695.203	29,406.968
	30,711.129	29,402.547
	30,735.231	29,395.782
	30,741.955	29,397.154

to the point of commencement.

THE SCHEDULE — *continued*

First column
The Authority

Second column
Protected Place

The boundaries of “FORT CANNING SERVICE RESERVOIR” are more particularly delineated in the Plan set out below.

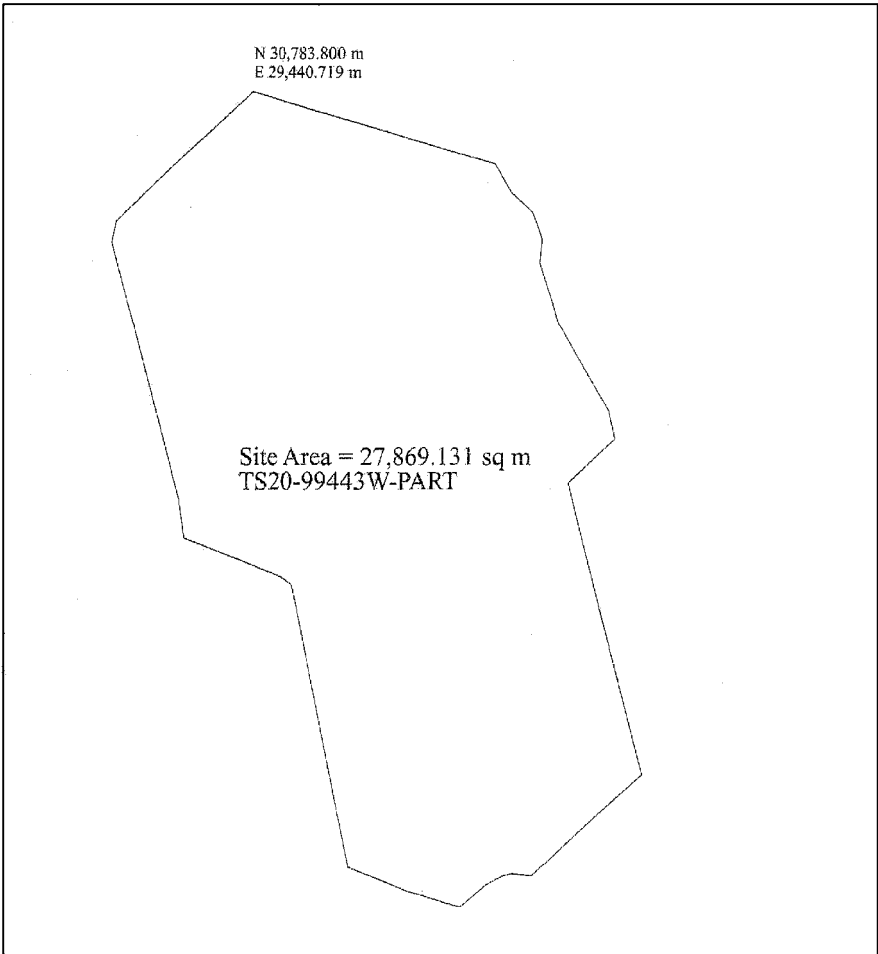

 THE SCHEDULE — *continued*

First column
The Authority

Second column
Protected Place

(7) JALAN EUNOS SERVICE RESERVOIR.

All that area comprised in part of State Land Lot MK23-99405A-PART, off Kaki Bukit Avenue 4, occupied by “JALAN EUNOS SERVICE RESERVOIR” containing an area of about 26,824.934 square metres and bounded approximately as follows:

Commencing at the corner of the aforesaid “JALAN EUNOS SERVICE RESERVOIR” which point is 35,858.803 metres North and 36,388.371 metres East of the Singapore Land Authority SVY 21 Datum, the boundaries run along successive lines of co-ordinates approximately as follows:

<i>Northing</i>	<i>Easting</i>
35,823.866	36,424.107
35,746.335	36,504.058
35,735.842	36,504.951
35,669.268	36,440.649
35,656.475	36,441.390
35,639.416	36,457.927
35,611.732	36,427.708
35,629.988	36,394.732
35,640.152	36,391.951
35,647.749	36,386.360
35,699.825	36,294.597
35,715.864	36,277.790
35,800.605	36,360.930
35,855.481	36,388.208

to the point of commencement.

THE SCHEDULE — *continued*

First column
The Authority

Second column
Protected Place

The boundaries of “JALAN EUNOS SERVICE RESERVOIR” are more particularly delineated in the Plan set out below.

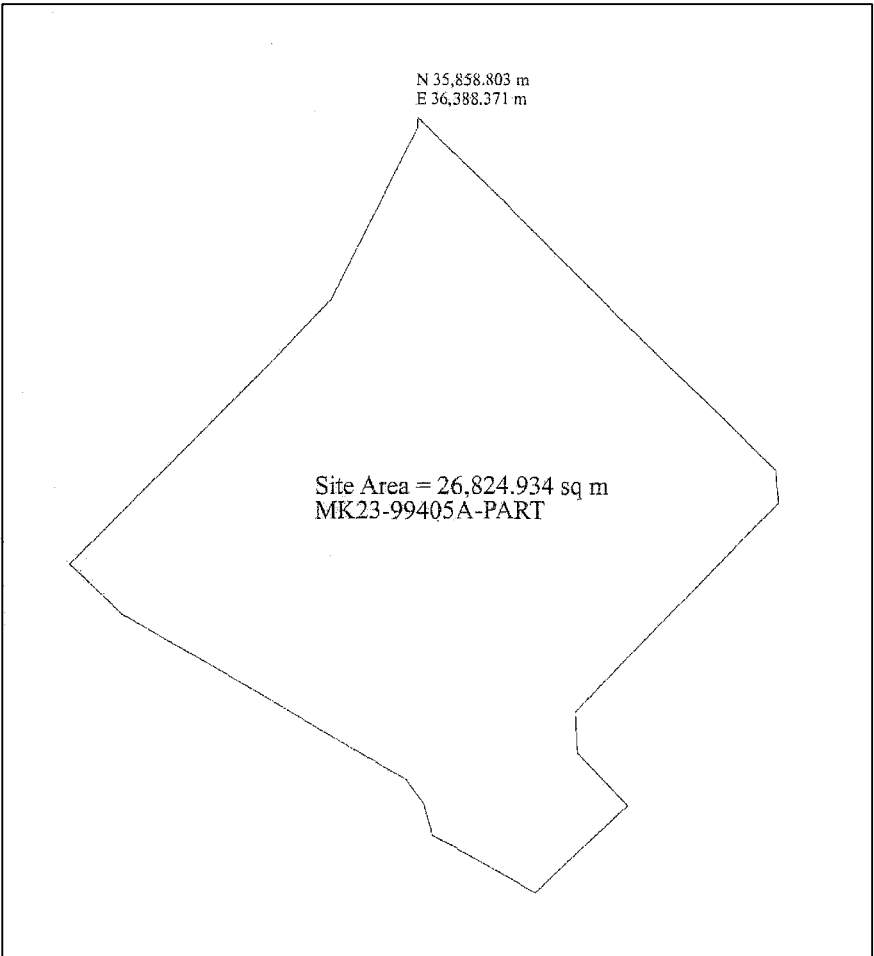

 THE SCHEDULE — *continued*

<i>First column</i>	<i>Second column</i>
The Authority	Protected Place
	(8) BUKIT BATOK SERVICE RESERVOIR.
	All that area comprised in part of State Land Lot MK10-3051C-PART, Bukit Batok West Avenue 5, occupied by “BUKIT BATOK SERVICE RESERVOIR” containing an area of about 24,395.496 square metres and bounded approximately as follows:
	Commencing at the corner of the aforesaid “BUKIT BATOK SERVICE RESERVOIR” which point is 37,587.393 metres North and 18,571.668 metres East of the Singapore Land Authority SVY 21 Datum, the boundaries run along successive lines of co-ordinates approximately as follows:
<i>Northing</i>	<i>Easting</i>
37,577.363	18,574.546
37,573.194	18,576.048
37,566.849	18,578.579
37,563.445	18,580.120
37,558.279	18,582.774
37,553.104	18,585.817
37,550.443	18,587.572
37,544.408	18,592.023
37,537.730	18,597.481
37,533.002	18,601.757
37,528.977	18,605.691
37,526.213	18,608.752
37,523.785	18,612.039
37,494.843	18,661.533
37,492.667	18,664.675
37,490.077	18,668.048
37,488.025	18,670.186
37,485.760	18,671.790
37,483.272	18,672.916
37,481.259	18,673.529

THE SCHEDULE — *continued*

<i>First column</i>		<i>Second column</i>
The Authority		Protected Place
	37,478.092	18,674.193
	37,474.884	18,674.622
	37,471.306	18,674.971
	37,468.364	18,675.015
	37,475.310	18,674.576
	37,337.163	18,652.085
	37,342.291	18,635.979
	37,369.639	18,546.461
	37,371.547	18,541.214
	37,377.460	18,522.658
	37,386.207	18,514.537
	37,388.915	18,514.543
	37,397.210	18,514.708
	37,439.926	18,524.849
	37,481.691	18,537.350
	37,502.881	18,543.650
	37,504.021	18,544.056
	37,506.945	18,544.678
	37,512.613	18,544.237
	37,524.827	18,547.943
	37,581.373	18,557.671
	37,585.151	18,562.887

to the point of commencement.

THE SCHEDULE — *continued*

First column
The Authority

Second column
Protected Place

The boundaries of “BUKIT BATOK SERVICE RESERVOIR” are more particularly delineated in the Plan set out below.

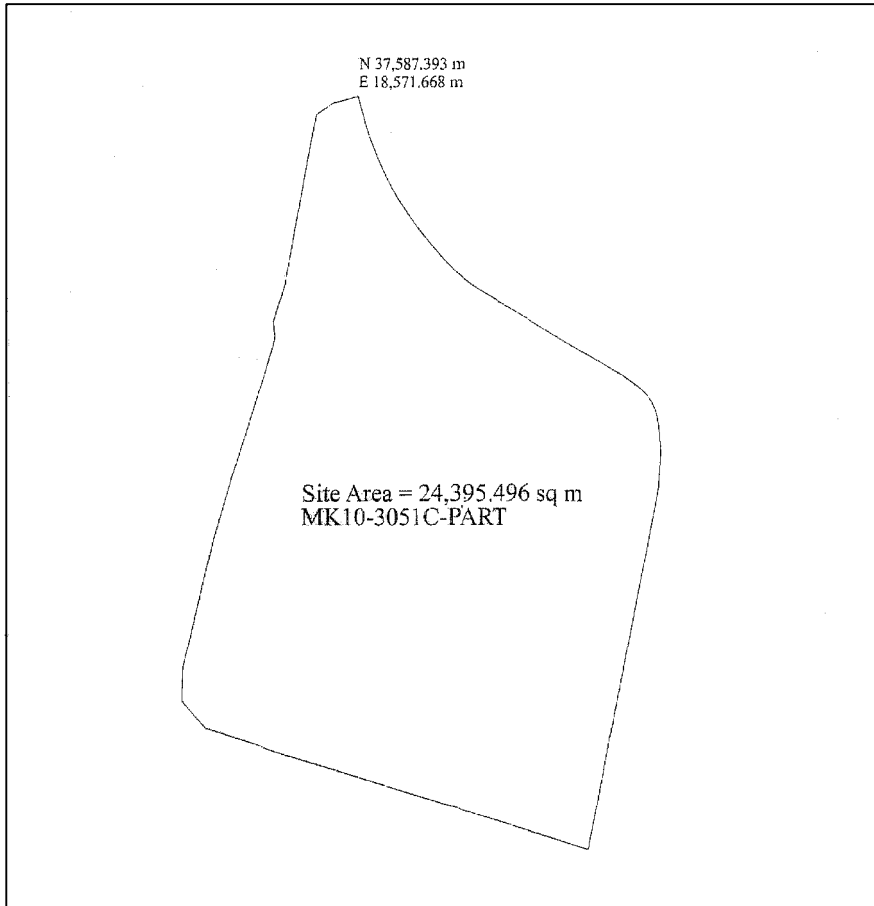

 THE SCHEDULE — *continued*

First column
The Authority

Second column
Protected Place

(9) PEARL'S HILL SERVICE RESERVOIR.

All that area comprised in part of State Land Lot TS22-120V-PART, end of Pearl's Bank, occupied by "PEARL'S HILL SERVICE RESERVOIR" containing an area of about 12,927.681 square metres and bounded approximately as follows:

Commencing at the corner of the aforesaid "PEARL'S HILL SERVICE RESERVOIR" which point is 29,734.813 metres North and 28,721.700 metres East of the Singapore Land Authority SVY 21 Datum, the boundaries run along successive lines of co-ordinates approximately as follows:

<i>Northings</i>	<i>Easting</i>
29,734.210	28,729.782
29,727.426	28,738.781
29,720.201	28,757.711
29,717.155	28,765.085
29,716.537	28,766.443
29,700.315	28,780.765
29,683.990	28,794.966
29,653.355	28,807.440
29,643.291	28,799.230
29,618.822	28,778.301
29,614.597	28,766.974
29,603.878	28,738.244
29,596.666	28,719.025
29,622.152	28,688.919
29,636.037	28,672.295
29,654.654	28,651.505
29,665.740	28,660.470
29,670.513	28,664.598
29,709.134	28,696.785

THE SCHEDULE — *continued*

<i>First column</i>	<i>Second column</i>
The Authority	Protected Place
29,723.757	28,709.148
29,731.796	28,716.574

to the point of commencement.

The boundaries of “PEARL’S HILL SERVICE RESERVOIR” are more particularly delineated in the Plan set out below.

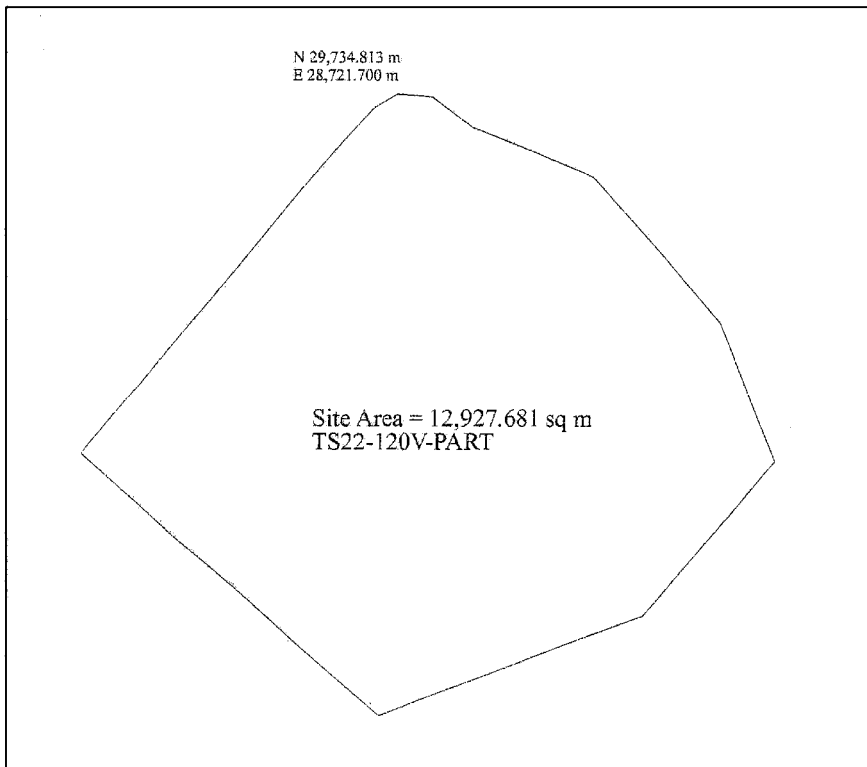

 THE SCHEDULE — *continued*

First column
The Authority

Second column
Protected Place

(10) KENT RIDGE SERVICE RESERVOIR.

All that area comprised in part of State Land Lot MK03-1097T-PART, off Stockport Road, occupied by “KENT RIDGE SERVICE RESERVOIR” containing an area of about 11,892.533 square metres and bounded approximately as follows:

Commencing at the corner of the aforesaid “KENT RIDGE SERVICE RESERVOIR” which point is 30,399.402 metres North and 22,459.421 metres East of the Singapore Land Authority SVY 21 Datum, the boundaries run along successive lines of co-ordinates approximately as follows:

<i>Northing</i>	<i>Easting</i>
30,396.443	22,462.732
30,392.793	22,476.138
30,376.998	22,491.577
30,361.611	22,507.625
30,339.918	22,533.005
30,326.298	22,550.563
30,307.053	22,576.683
30,299.638	22,587.983
30,296.321	22,588.530
30,278.660	22,588.300
30,275.624	22,591.713
30,252.361	22,601.187
30,228.781	22,571.946
30,246.446	22,535.889
30,246.944	22,534.874
30,253.422	22,521.488
30,258.355	22,525.159
30,267.798	22,531.933
30,361.044	22,420.217

THE SCHEDULE — *continued*

<i>First column</i>	<i>Second column</i>
The Authority	Protected Place
30,399.368	22,452.438
30,395.910	22,456.552

to the point of commencement.

The boundaries of “KENT RIDGE SERVICE RESERVOIR” are more particularly delineated in the Plan set out below.

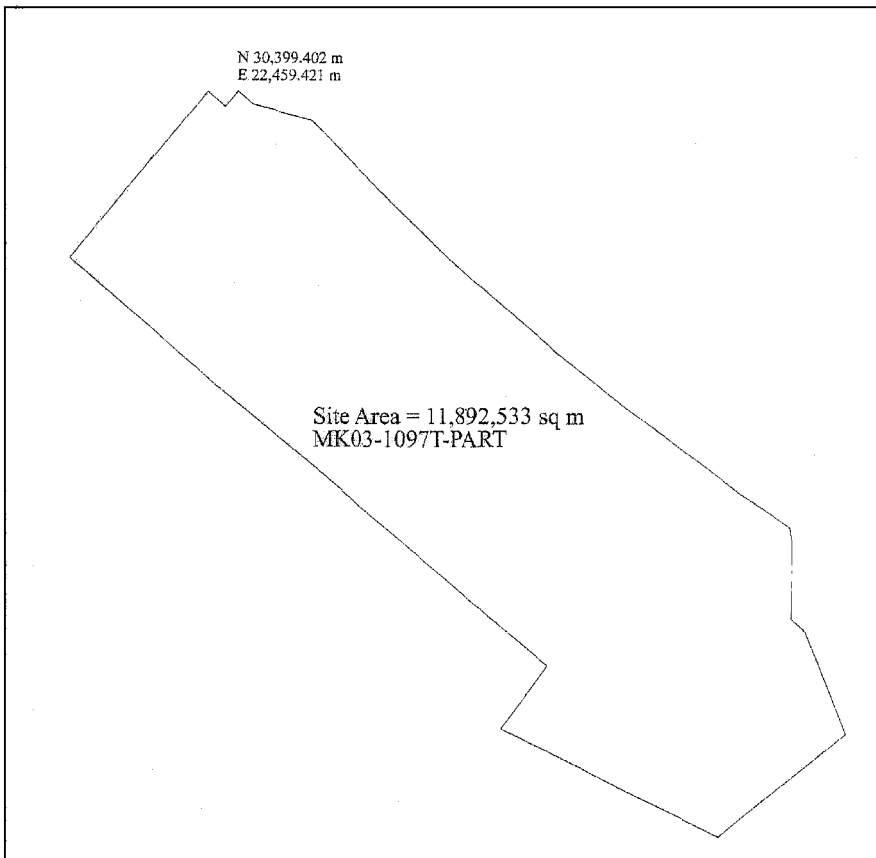

 THE SCHEDULE — *continued*

First column
The Authority

Second column
Protected Place

(11) MOUNT FABER II SERVICE RESERVOIR.

All that area comprised in part of State Land Lot MK01-814L-PART, off Telok Blangah Green, occupied by “MOUNT FABER II SERVICE RESERVOIR” containing an area of about 12,897.825 square metres and bounded approximately as follows:

Commencing at the corner of the aforesaid “MOUNT FABER II SERVICE RESERVOIR” which point is 29,184.142 metres North and 25,162.643 metres East of the Singapore Land Authority SVY 21 Datum, the boundaries run along successive lines of co-ordinates approximately as follows:

<i>Northings</i>	<i>Easting</i>
29,158.840	25,238.699
29,176.031	25,243.922
29,169.368	25,264.603
29,152.047	25,258.560
29,129.684	25,326.443
29,127.440	25,325.834
29,120.003	25,347.701
29,077.629	25,334.483
29,078.482	25,324.769
29,067.393	25,324.818
29,066.062	25,293.429
29,063.680	25,275.512
29,062.588	25,273.093
29,062.084	25,249.869
29,083.923	25,223.980
29,106.793	25,231.894
29,135.120	25,146.593

to the point of commencement.

THE SCHEDULE — *continued*

First column
The Authority

Second column
Protected Place

The boundaries of “MOUNT FABER II SERVICE RESERVOIR” are more particularly delineated in the Plan set out below.

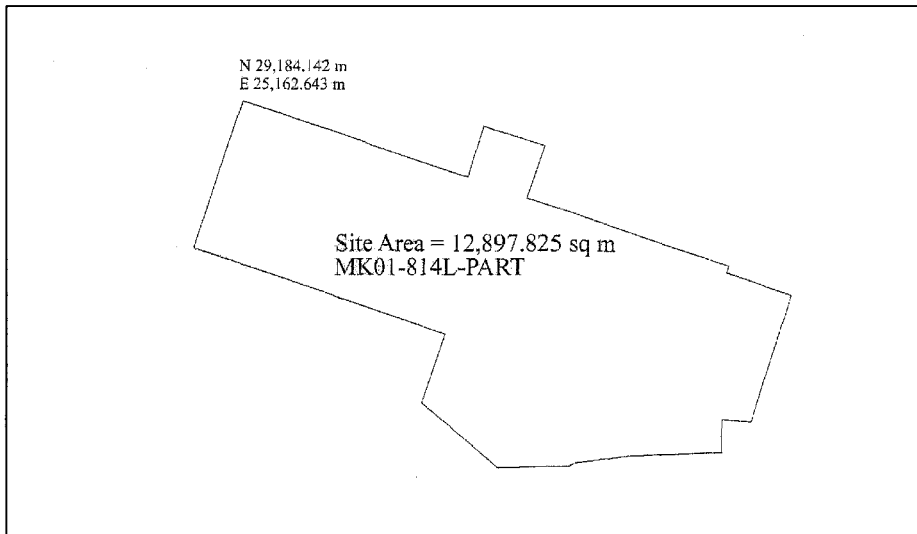

 THE SCHEDULE — *continued*

First column
The Authority

Second column
Protected Place

(12) BUKIT PANJANG SERVICE RESERVOIR.

All that area comprised in part of State Land Lot MK14-664W-PART, off Fajar Road, occupied by “BUKIT PANJANG SERVICE RESERVOIR” containing an area of about 8,720.323 square metres and bounded approximately as follows:

Commencing at the corner of the aforesaid “BUKIT PANJANG SERVICE RESERVOIR” which point is 40,558.155 metres North and 21,197.993 metres East of the Singapore Land Authority SVY 21 Datum, the boundaries run along successive lines of co-ordinates approximately as follows:

<i>Northings</i>	<i>Easting</i>
40,557.819	21,204.220
40,553.229	21,215.558
40,548.936	21,223.130
40,543.450	21,230.366
40,537.142	21,236.557
40,529.566	21,241.966
40,521.578	21,245.996
40,512.882	21,248.645
40,504.148	21,249.989
40,494.892	21,250.140
40,486.420	21,248.948
40,477.724	21,246.377
40,468.440	21,241.799
40,462.198	21,237.652
40,455.330	21,231.239
40,449.460	21,223.900
40,445.328	21,216.509
40,441.964	21,207.842
40,437.193	21,191.690
40,437.764	21,191.138

THE SCHEDULE — *continued*

<i>First column</i>	<i>Second column</i>
The Authority	Protected Place
40,448.999	21,180.308
40,455.317	21,174.217
40,464.115	21,165.734
40,473.793	21,159.058
40,482.576	21,154.669
40,490.525	21,152.504
40,503.017	21,151.406
40,514.960	21,153.551
40,523.146	21,155.744
40,530.753	21,158.941
40,536.694	21,164.133
40,542.666	21,169.876
40,548.141	21,176.092
40,552.780	21,183.337

to the point of commencement.

THE SCHEDULE — *continued*

First column
The Authority

Second column
Protected Place

The boundaries of “BUKIT PANJANG SERVICE RESERVOIR” are more particularly delineated in the Plan set out below.

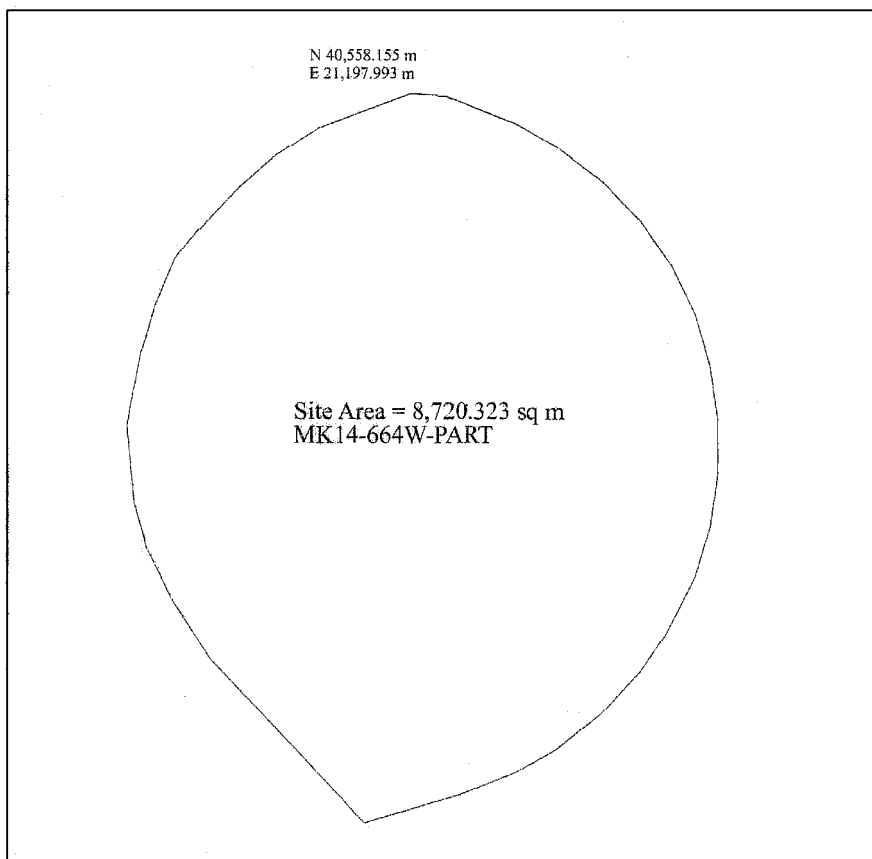

 THE SCHEDULE — *continued*

First column
The Authority

Second column
Protected Place

(13) JURONG HILL 65 SERVICE RESERVOIR.

All that area comprised in part of State Land Lot MK06-2959N-PART, off Benoi Road, occupied by “JURONG HILL 65 SERVICE RESERVOIR” containing an area of about 15,973.375 square metres and bounded approximately as follows:

Commencing at the corner of the aforesaid “JURONG HILL 65 SERVICE RESERVOIR” which point is 34,153.818 metres North and 11,072.583 metres East of the Singapore Land Authority SVY 21 Datum, the boundaries run along successive lines of co-ordinates approximately as follows:

<i>Northing</i>	<i>Easting</i>
34,151.851	11,147.487
34,120.454	11,136.787
34,099.845	11,150.263
34,097.687	11,150.640
34,072.250	11,150.412
34,055.326	11,148.529
34,044.082	11,145.832
34,029.738	11,140.402
34,014.784	11,127.840
34,009.924	11,120.174
34,008.226	11,113.501
34,007.800	11,106.086
34,009.365	11,096.385
34,029.437	11,054.589
34,039.097	11,039.089
34,042.701	11,030.480
34,048.437	11,009.704
34,060.268	10,995.415
34,086.188	11,020.725
34,099.530	11,027.551
34,106.168	11,029.345

THE SCHEDULE — *continued*

<i>First column</i>	<i>Second column</i>
The Authority	Protected Place
34,133.589	11,032.989
34,147.184	11,043.082
34,147.712	11,056.201

to the point of commencement.

The boundaries of “JURONG HILL 65 SERVICE RESERVOIR” are more particularly delineated in the Plan set out below.

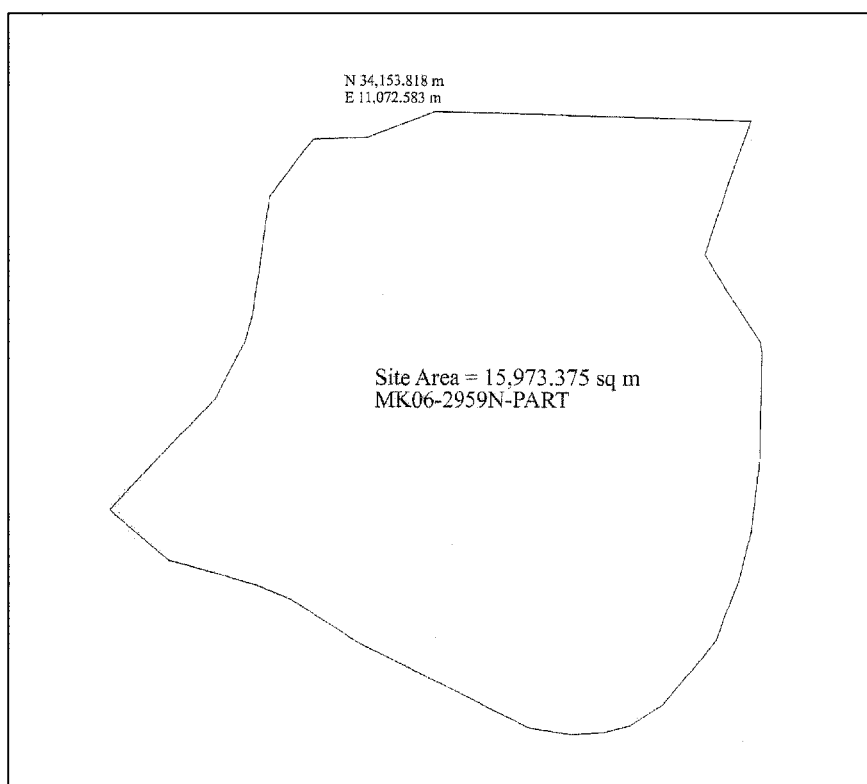

Made this 18th day of January 2006.

BENNY LIM
*Permanent Secretary,
Ministry of Home Affairs,
Singapore.*

[CP/C/198/39/1; MHA (PS) 12/2/02 TF 1;
AG/LEG/SL/256/2002/1 Vol. 7]